

**WAIVER**

The provisions and details contained in this document are based on the International Residential Code (IRC) and best building practices at the time of writing. Other prescriptive construction methods recommended meet or exceed the minimum requirements of the IRC. Where any differences exist between details in this documents and the IRC, provisions of the IRC shall apply. This document does not prevent the use of other construction techniques or materials. All construction and materials must be approved by the authority having jurisdiction. Every effort has been made to reflect the language and intent of the IRC. However, no assurance can be made that designs and construction made in accordance with this plan meet the requirements of any particular jurisdiction.

**SUMMARY**

SIZE: 226.5 SQ.FT.  
WIDTH: 20 FT.  
LENGTH: 20 FT.  
HEIGHT: 4 FT 6.25 IN  
LEVELS: ONE

FINAL CONSTRUCTION PLANS AND PERMIT PLANS MAY BE ALTERED TO REPRESENT BUILDING CODE REQUIREMENTS AND ON-SITE CONDITIONS.

**DRAWING SET**

Label	Title
A0	PERSPECTIVES
A1.0	FOUNDATION PLAN
A1.2	GROUND FLOOR PLAN
A2.0	CURVED JOIST DETAILS & FRONT ELEVATION
A2.1	SIDE ELEVATIONS
A3.0	LEDGER BOARD DETAILS
A3.1	DECK FRAMING DETAILS
A3.2	RAILING DETAILS
A3.3	STAIR GUARDRAIL DETAILS
A3.4	OPTIONAL ATTACHMENT DETAILS
A3.5	BENCH DETAIL
A4.0	MATERIAL LIST

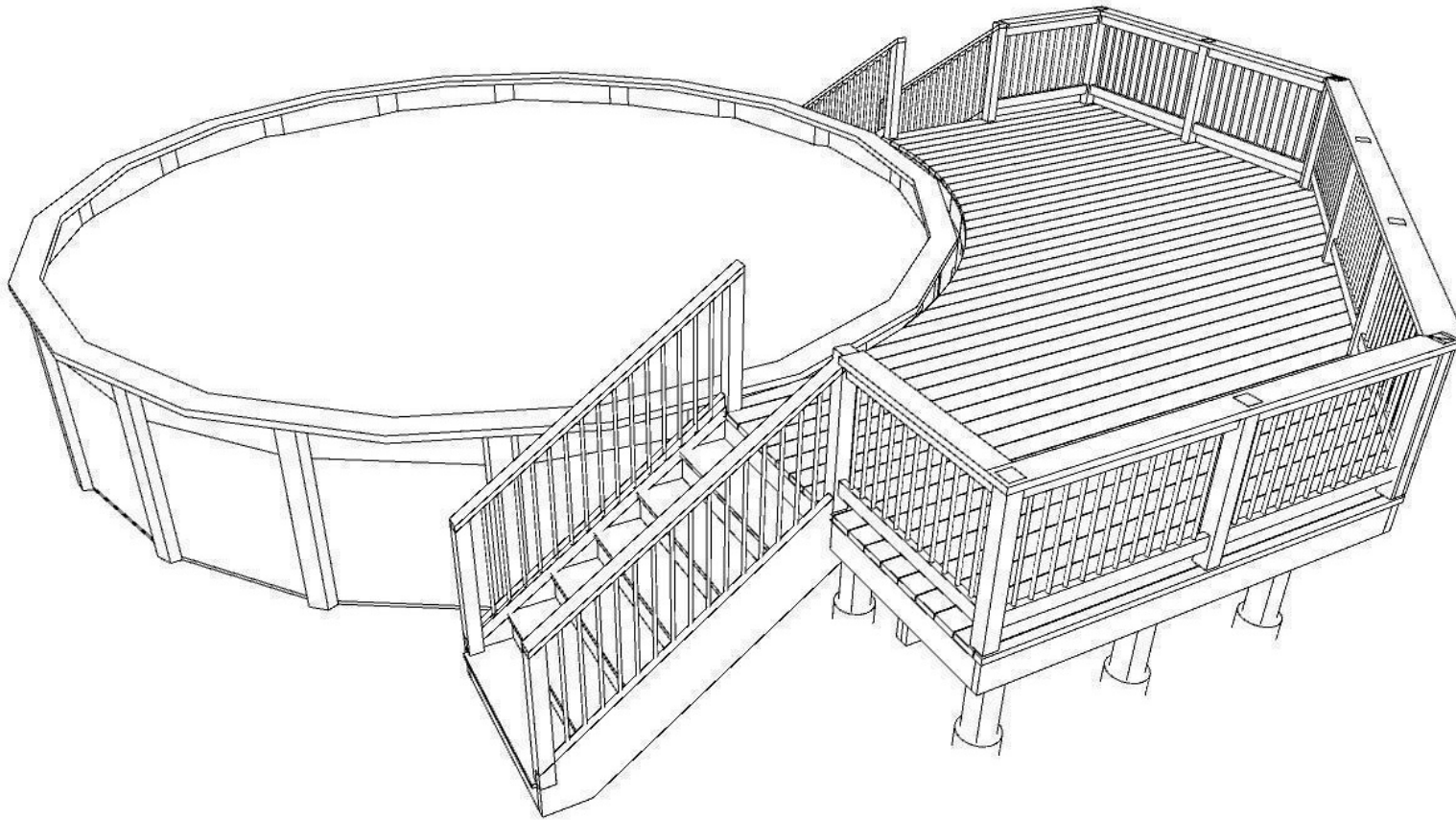

#	DESCRIPTION	mm/dd/yy
PROJECT		
DecksGo Plan#18-46a		
DRAWING		
PERSPECTIVES		
DRAWN BY	Richard Bergman	SCALE NTS
© decksgo.com	All Rights Reserved	SHEET A0
DATE	JAN 21, 2022	



www.decksgo.com  
Toll: 1-844-833-3257

USA  
808 Commerce Park Drive, Unit 16348  
Ogdensburg, NY 13669

CAN  
5390 Canotek Road, Unit 14  
Ottawa, ON K1J 1H8

**WAIVER**

The provisions and details contained in this document are based on the International Residential Code (IRC) and best building practices at the time of writing. Other prescriptive construction methods recommended meet or exceed the minimum requirements of the IRC. Where any differences exist between details in this documents and the IRC, provisions of the IRC shall apply. This document does not prevent the use of other construction techniques or materials. All construction and materials must be approved by the authority having jurisdiction. Every effort has been made to reflect the language and intent of the IRC. However, no assurance can be made that designs and construction made in accordance with this plan meet the requirements of any particular jurisdiction.

**SUMMARY**

SIZE: 226.5 SQ.FT.  
WIDTH: 20 FT.  
LENGTH: 20 FT.  
HEIGHT: 4 FT 6.25 IN  
LEVELS: ONE

FINAL CONSTRUCTION PLANS AND PERMIT PLANS MAY BE ALTERED TO REPRESENT BUILDING CODE REQUIREMENTS AND ON-SITE CONDITIONS.

#	DESCRIPTION	mm/dd/yy

**PROJECT**

DecksGo Plan#18-46a

**DRAWING**

FOUNDATION PLAN

**DRAWN BY**

Richard Bergman

**SCALE**

AS SHOWN

**SHEET**

JAN 21, 2022

**A1.0**

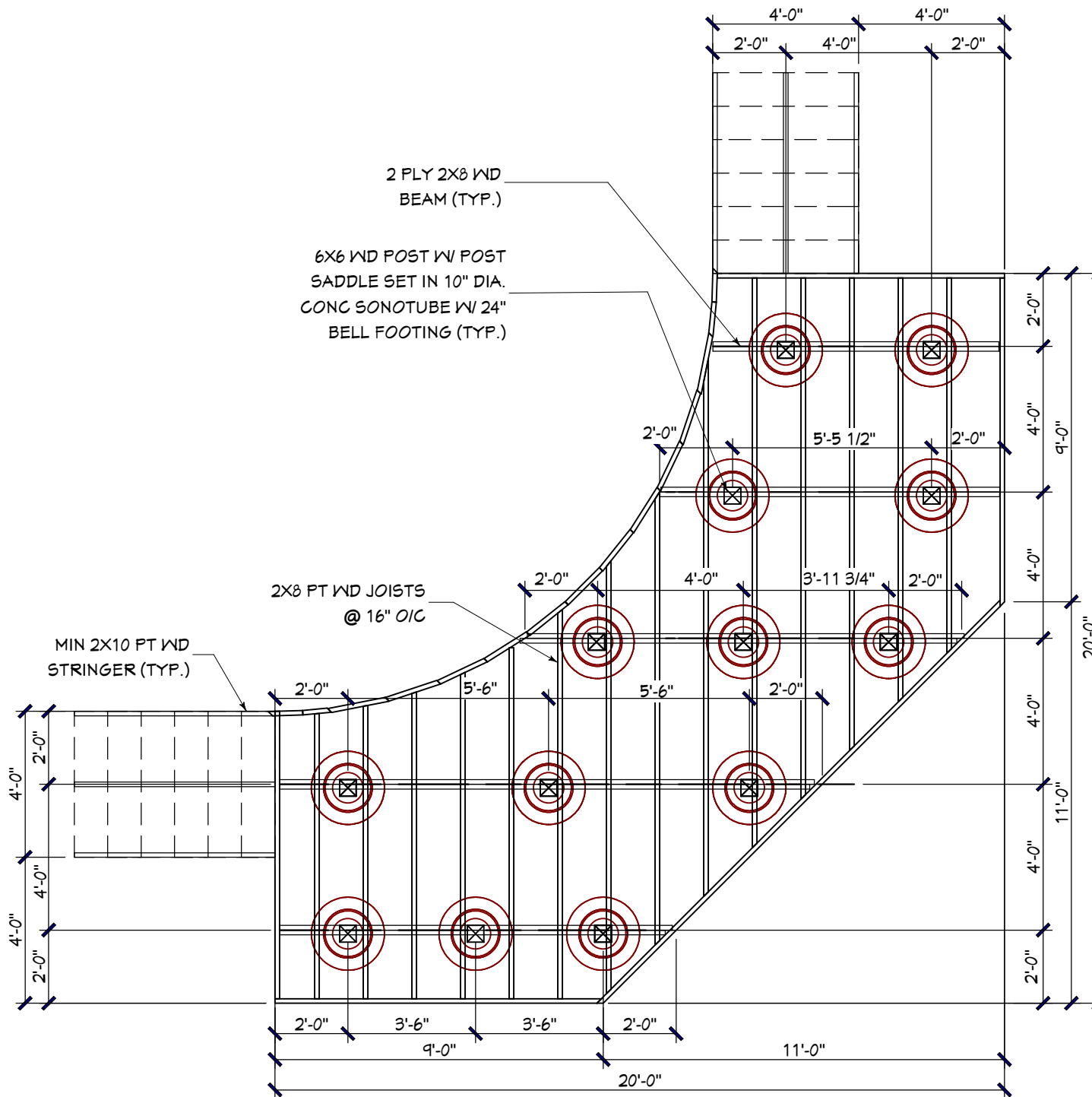

2 PLY 2X8 WD  
BEAM (TYP.)

6X6 WD POST W POST  
SADDLE SET IN 10" DIA.  
CONC SONOTUBE W/ 24"  
BELL FOOTING (TYP.)

2X8 PT WD JOISTS  
@ 16" O/C

MIN 2X10 PT WD  
STRINGER (TYP.)



www.decksgo.com  
Toll: 1-844-833-3257

USA  
808 Commerce Park Drive, Unit 16348  
Ogdensburg, NY 13669

CAN  
5390 Canotek Road, Unit 14  
Ottawa, ON K1J 1H8

**WAIVER**

The provisions and details contained in this document are based on the International Residential Code (IRC) and best building practices at the time of writing. Other prescriptive construction methods recommended meet or exceed the minimum requirements of the IRC. Where any differences exist between details in this documents and the IRC, provisions of the IRC shall apply. This document does not prevent the use of other construction techniques or materials. All construction and materials must be approved by the authority having jurisdiction. Every effort has been made to reflect the language and intent of the IRC. However, no assurance can be made that designs and construction made in accordance with this plan meet the requirements of any particular jurisdiction.

**SUMMARY**

SIZE: 226.5 SQ.FT.  
WIDTH: 20 FT.  
LENGTH: 20 FT.  
HEIGHT: 4 FT 6.25 IN  
LEVELS: ONE

FINAL CONSTRUCTION PLANS AND PERMIT PLANS MAY BE ALTERED TO REPRESENT BUILDING CODE REQUIREMENTS AND ON-SITE CONDITIONS.

#	DESCRIPTION	mm/dd/yy

PROJECT	
DecksGo Plan#18-46a	
DRAWING	
GROUND FLOOR PLAN	
DRAWN BY	SCALE
Richard Bergman	AS SHOWN
© decksgo.com	SHEET
All Rights Reserved	A1.2
DATE	
JAN 21, 2022	

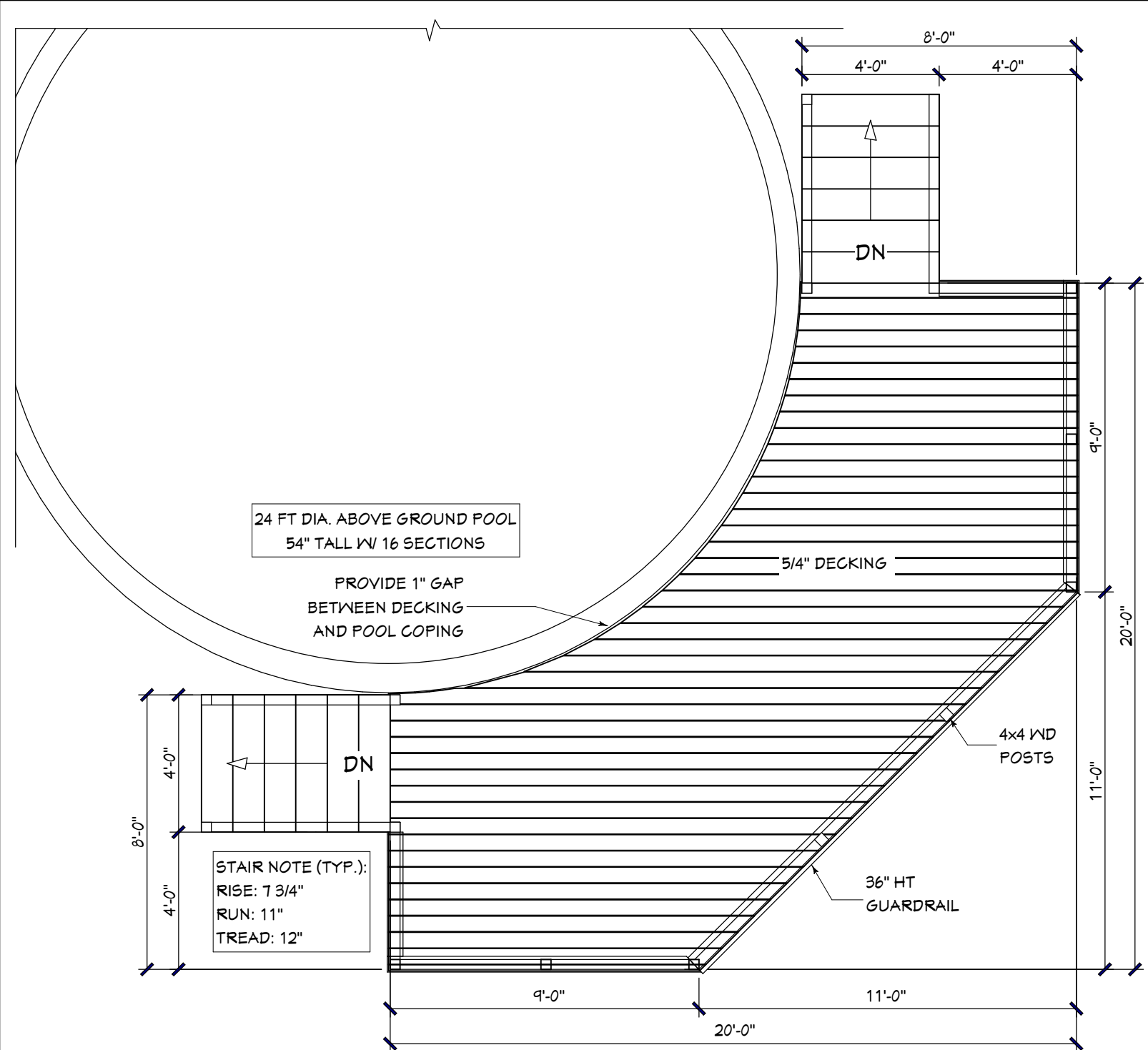

24 FT DIA. ABOVE GROUND POOL  
54" TALL W/ 16 SECTIONS

PROVIDE 1" GAP  
BETWEEN DECKING  
AND POOL COPING

STAIR NOTE (TYP.):  
RISE: 7 3/4"  
RUN: 11"  
TREAD: 12"

**WAIVER**

The provisions and details contained in this document are based on the International Residential Code (IRC) and best building practices at the time of writing. Other prescriptive construction methods recommended meet or exceed the minimum requirements of the IRC. Where any differences exist between details in this documents and the IRC, provisions of the IRC shall apply. This document does not prevent the use of other construction techniques or materials. All construction and materials must be approved by the authority having jurisdiction. Every effort has been made to reflect the language and intent of the IRC. However, no assurance can be made that designs and construction made in accordance with this plan meet the requirements of any particular jurisdiction.

**SUMMARY**

SIZE: 226.5 SQ.FT.  
WIDTH: 20 FT.  
LENGTH: 20 FT.  
HEIGHT: 4 FT 6.25 IN  
LEVELS: ONE

FINAL CONSTRUCTION PLANS AND PERMIT PLANS MAY BE ALTERED TO REPRESENT BUILDING CODE REQUIREMENTS AND ON-SITE CONDITIONS.

#	DESCRIPTION	mm/dd/yy

PROJECT  
**DecksGo Plan#18-46a**

DRAWING  
**CURVED JOIST DETAILS & FRONT ELEVATION**

DRAWN BY Richard Bergman	SCALE AS SHOWN
© decksgo.com All Rights Reserved	SHEET <b>A2.0</b>
DATE JAN 21, 2022	

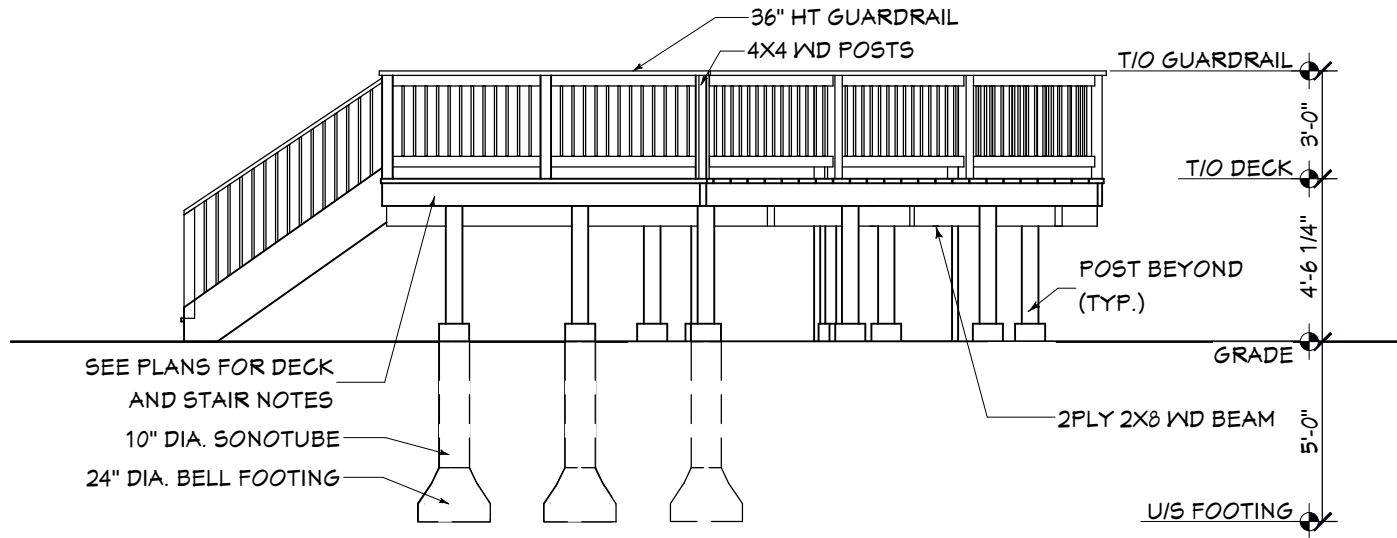

**01**  
**A2.0** FRONT ELEVATION  
SCALE: 3/16"=1' 0"

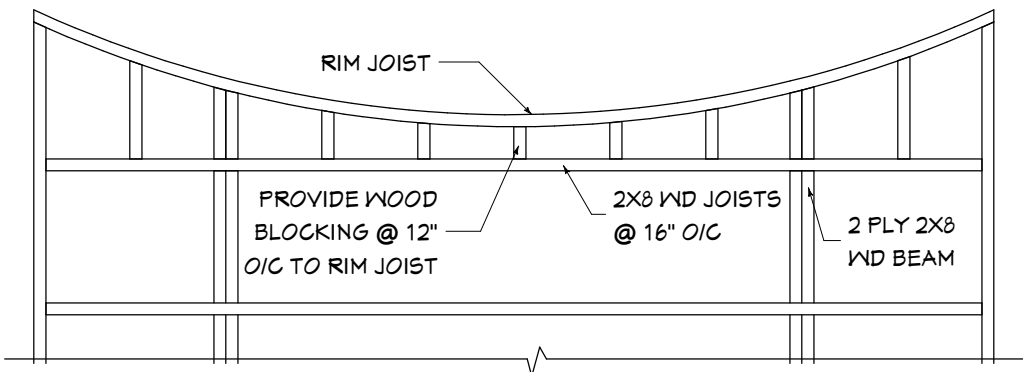

**RIM JOIST/ FASCIA DETAIL**

APPLY BEADS OF CONSTRUCTION ADHESIVE ALONG KERF CUTS AND THEN SCREW RIM JOIST TO JOISTS. TYPICAL FOR 1X8 & 1X10 FASCIA BOARDS.

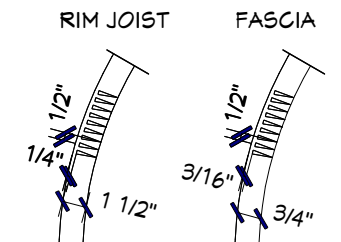

**02**  
**A2.0** FRAMING DETAILS  
SCALE: 1/2"=1' 0"

**WAIVER**

The provisions and details contained in this document are based on the International Residential Code (IRC) and best building practices at the time of writing. Other prescriptive construction methods recommended meet or exceed the minimum requirements of the IRC. Where any differences exist between details in this documents and the IRC, provisions of the IRC shall apply. This document does not prevent the use of other construction techniques or materials. All construction and materials must be approved by the authority having jurisdiction. Every effort has been made to reflect the language and intent of the IRC. However, no assurance can be made that designs and construction made in accordance with this plan meet the requirements of any particular jurisdiction.

**SUMMARY**

SIZE: 226.5 SQ.FT.  
WIDTH: 20 FT.  
LENGTH: 20 FT.  
HEIGHT: 4 FT 6.25 IN  
LEVELS: ONE

FINAL CONSTRUCTION PLANS AND PERMIT PLANS MAY BE ALTERED TO REPRESENT BUILDING CODE REQUIREMENTS AND ON-SITE CONDITIONS.

#	DESCRIPTION	mm/dd/yy

**PROJECT**

DecksGo Plan#18-46a

**DRAWING**

**SIDE ELEVATIONS**

DRAWN BY  
Richard Bergman

SCALE

© decksgo.com  
All Rights Reserved  
DATE  
JAN 21, 2022

SHEET  
**A2.1**

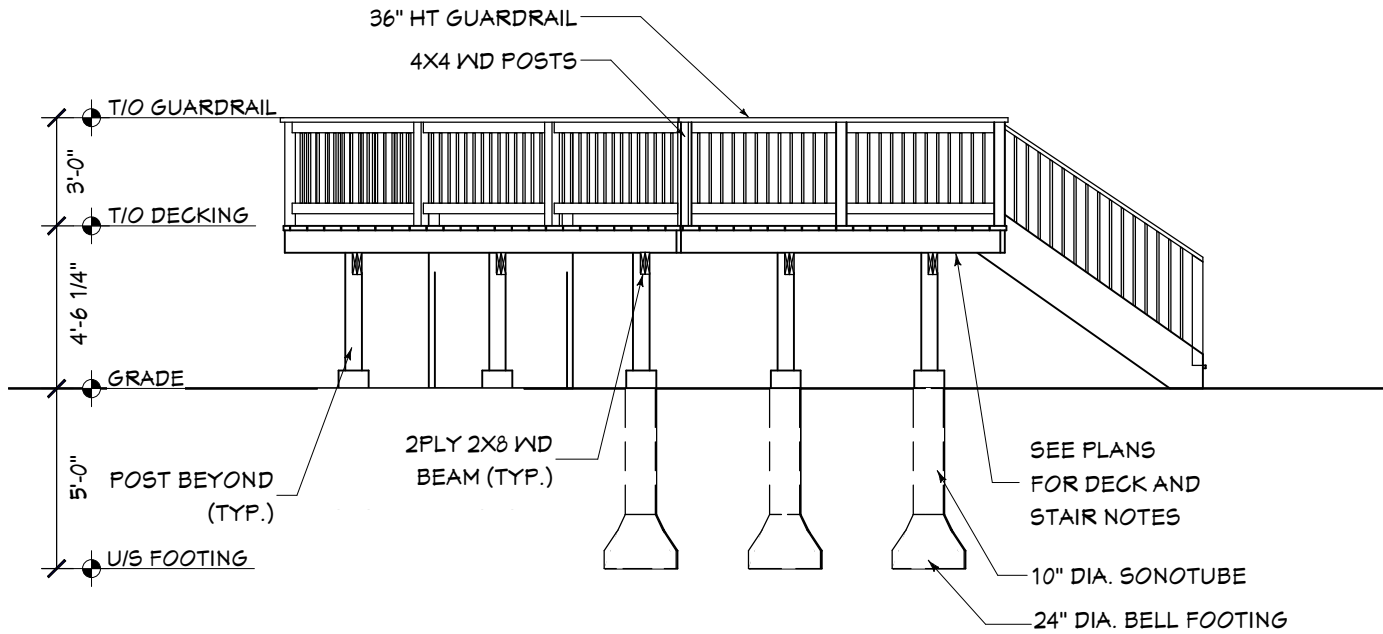

**01 RIGHT ELEVATION**  
A2.1 SCALE: 3/16"=1' 0"

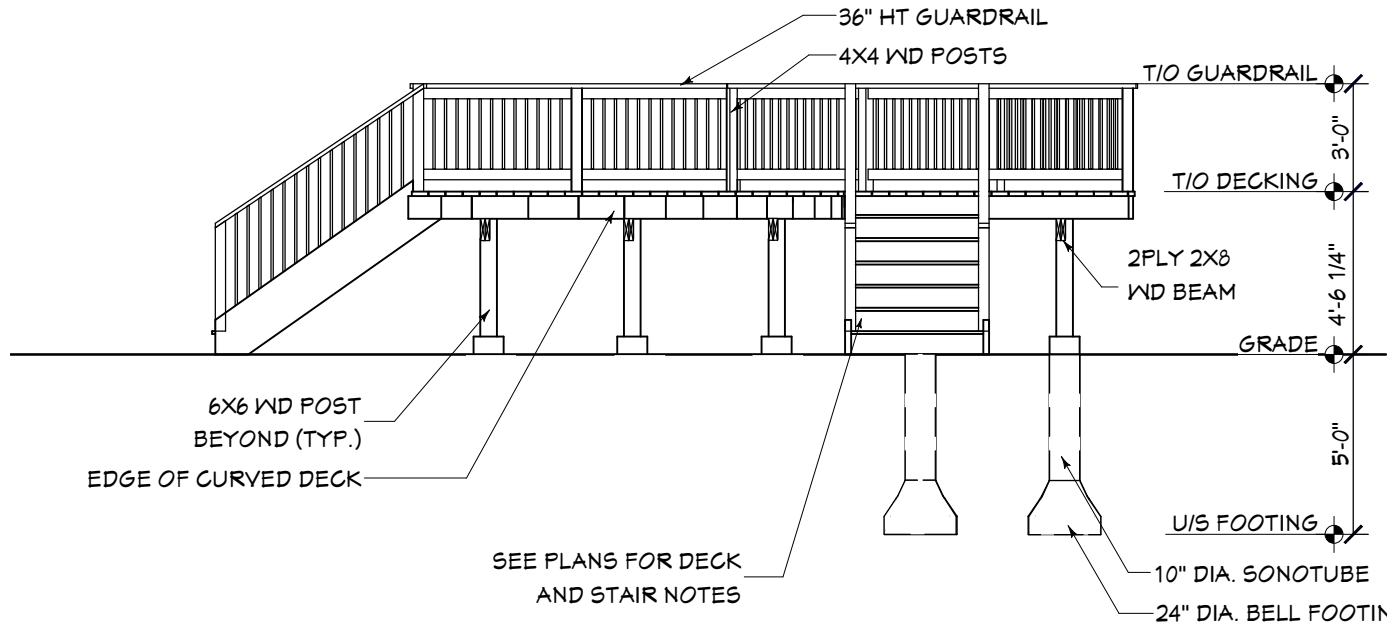

**02 LEFT ELEVATION**  
A2.1 SCALE: 3/16"=1' 0"

**LEDGER BOARD:**

**1. ATTACHMENT OF LEDGER BOARD TO RIM BOARD SECTION DETAIL:**

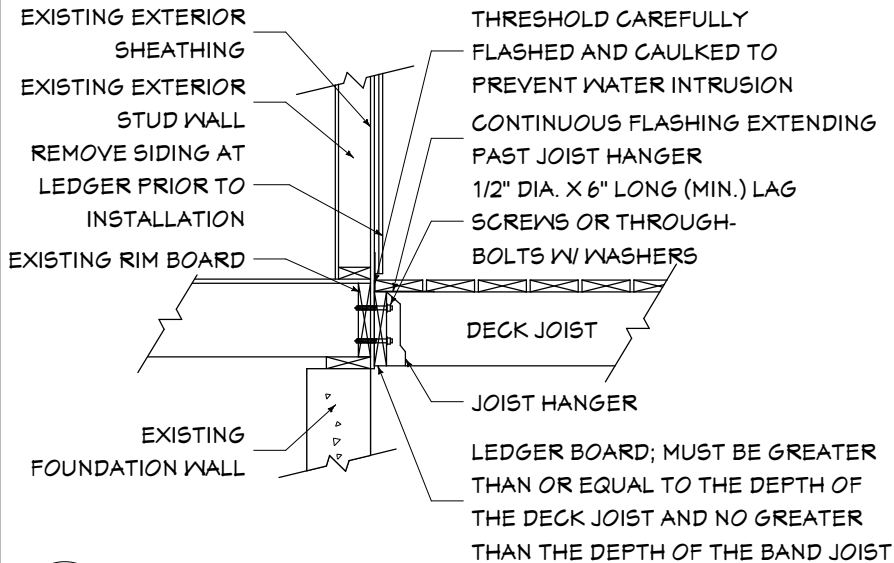

**01** LEDGER BOARD @ RIM JOIST DETAIL

**A3.0** SCALE: 1/2"=1' 0"

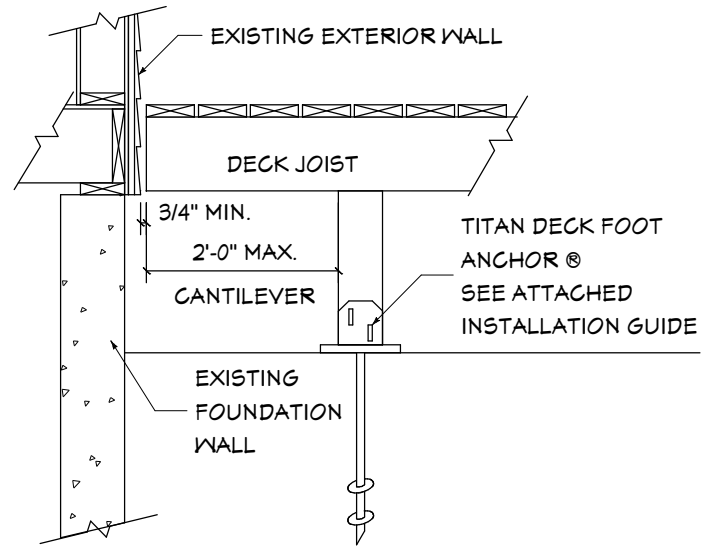

**02** OPTIONAL FREE STANDING DECK DETAIL

**A3.0** SCALE: 1/2"=1' 0"

**LEDGER BOARD:**

**2. ATTACHMENT OF LEDGER BOARD TO FOUNDATION WALL (CONCRETE OR SOLID MASONRY) SECTION DETAIL:**

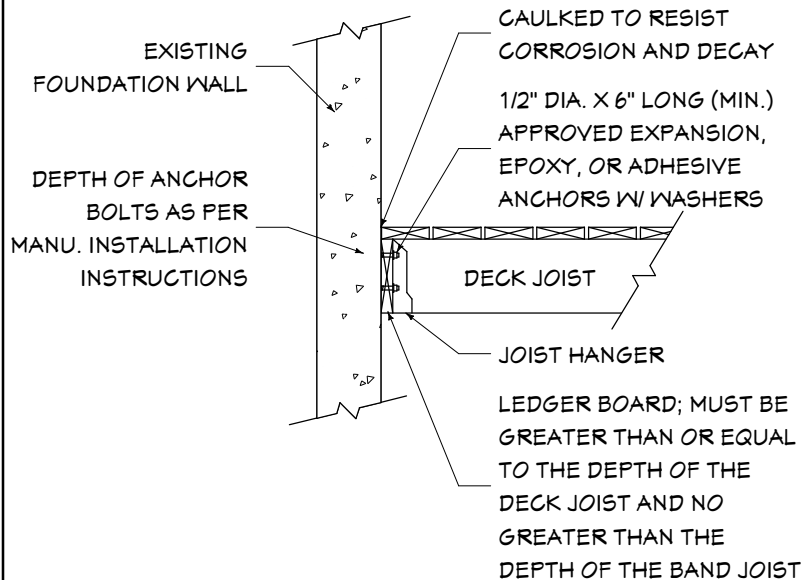

**03** LEDGER BOARD @ FOUNDATION WALL DETAIL

**A3.0** SCALE: 1/2"=1' 0"

**LEDGER BOARD:**

**3. ATTACHMENT OF LEDGER BOARD TO FOUNDATION WALL (HOLLOW MASONRY) SECTION DETAIL:**

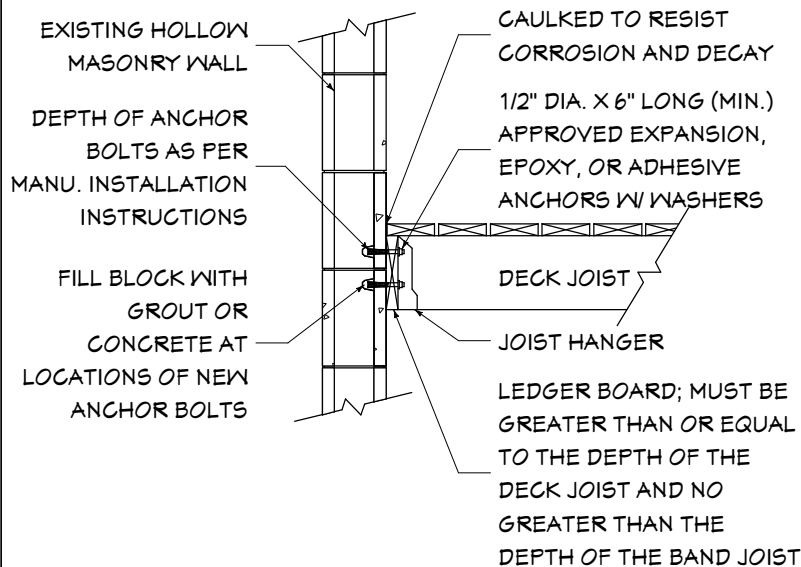

**04** LEDGER BOARD @ FOUNDATION WALL DETAIL

**A3.0** SCALE: 1/2"=1' 0"



www.decksgo.com  
Toll: 1-844-833-3257

USA  
808 Commerce Park Drive, Unit 16348  
Ogdensburg, NY 13669

CAN  
5390 Canotek Road, Unit 14  
Ottawa, ON K1J 1H8

**WAIVER**

The provisions and details contained in this document are based on the International Residential Code (IRC) and best building practices at the time of writing. Other prescriptive construction methods recommended meet or exceed the minimum requirements of the IRC. Where any differences exist between details in this documents and the IRC, provisions of the IRC shall apply. This document does not prevent the use of other construction techniques or materials. All construction and materials must be approved by the authority having jurisdiction. Every effort has been made to reflect the language and intent of the IRC. However, no assurance can be made that designs and construction made in accordance with this plan meet the requirements of any particular jurisdiction.

**SUMMARY**

SIZE: 226.5 SQ.FT.  
WIDTH: 20 FT.  
LENGTH: 20 FT.  
HEIGHT: 4 FT 6.25 IN  
LEVELS: ONE

FINAL CONSTRUCTION PLANS AND PERMIT PLANS MAY BE ALTERED TO REPRESENT BUILDING CODE REQUIREMENTS AND ON-SITE CONDITIONS.

#	DESCRIPTION	mm/dd/yy

**PROJECT**

DecksGo Plan#18-46a

**DRAWING**

LEDGER BOARD  
DETAILS

DRAWN BY  
Richard Bergman  
© decksgo.com  
All Rights Reserved  
DATE  
JAN 21, 2022

SCALE  
AS SHOWN

SHEET  
**A3.0**

**POST:**

1. ALL POSTS TO BE 6X6 PRESSURE TREATED WOOD POSTS
2. BEAM MUST BEAR FULLY ON 6X6 POST

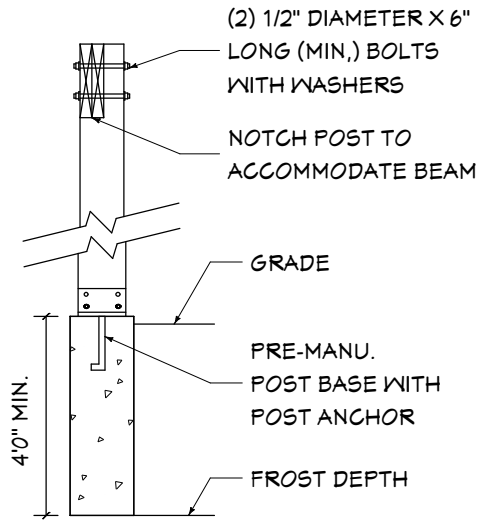

**FOUNDATION:**

1. ALL FOOTINGS MUST BEAR ON SOLID GROUND.
2. ALL POST TO FOOTING CONNECTIONS TO BE PRE-MANUFACTURED POST BASE WITH POST ANCHOR.
3. ALL POSTS TO BE CENTERED ON FOOTING.

**01 POST & FOOTING DETAILS**  
A3.1 SCALE: 1/2"=1' 0"

**OPTIONAL SURFACE MOUNTED POST:**

1. 6X6 POST TO BE ATTACHED TO CONCRETE SONO TUBES USING TITAN COMPRESSION POST BASE - SEE ATTACHED INSTALLATION GUIDE

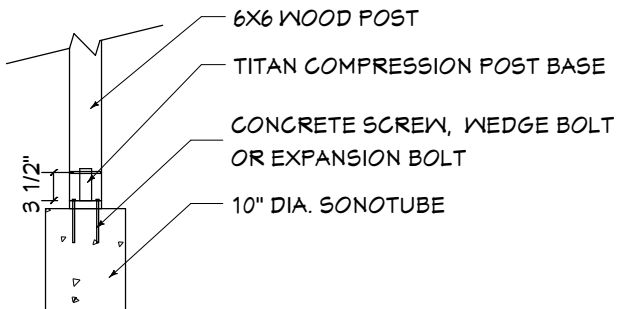

**03 OPTIONAL POST TO FOOTING DETAIL**  
A3.1 SCALE: 1/2"=1' 0"

**BEAMS:**

1. BEAMS TO BE CONSTRUCTED OF 2 - 2X8 PRESSURE TREATED WOOD MEMBERS. BUILDER TO USE NAIL PATTERN FOR LAMINATING BEAMS BELOW
2. BEAM MUST BEAR FULLY ON 6X6 POST

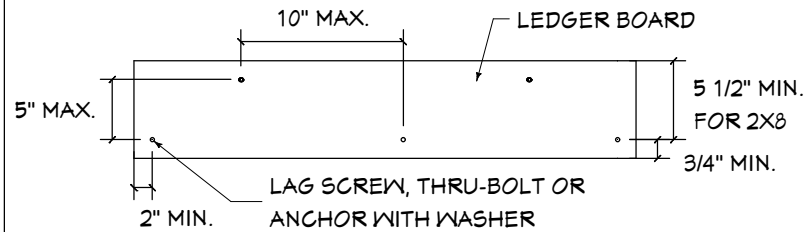
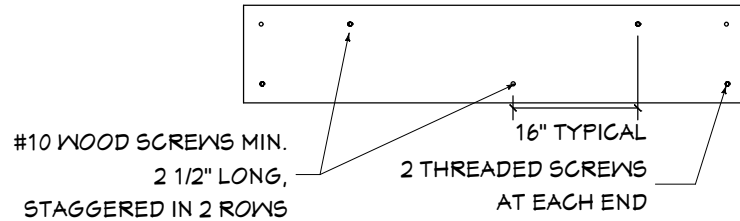

**02 BEAM AND LEDGER BOARD FASTENER DETAILS**  
A3.1 SCALE: 1/2"=1' 0"

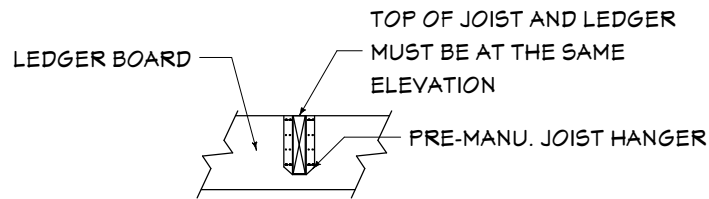

**JOISTS:**

1. JOISTS TO BE ATTACHED TO LEDGER USING PRE-MANU. JOIST HANGERS.
2. JOISTS TO BE ATTACHED TO BEAM USING PRE-MANUFACTURED MECHANICAL FASTENER OR HURRICANE CLIP, OR THREADED TOE-NAILS

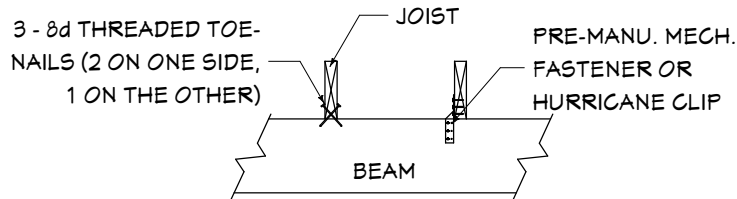

**04 JOIST CONNECTION DETAILS**  
A3.1 SCALE: 1/2"=1' 0"



www.decksgo.com  
Toll: 1-844-833-3257

USA  
808 Commerce Park Drive, Unit 16348  
Ogdensburg, NY 13669

CAN  
5390 Canotek Road, Unit 14  
Ottawa, ON K1J 1H8

**WAIVER**

The provisions and details contained in this document are based on the International Residential Code (IRC) and best building practices at the time of writing. Other prescriptive construction methods recommended meet or exceed the minimum requirements of the IRC. Where any differences exist between details in this documents and the IRC, provisions of the IRC shall apply. This document does not prevent the use of other construction techniques or materials. All construction and materials must be approved by the authority having jurisdiction. Every effort has been made to reflect the language and intent of the IRC. However, no assurance can be made that designs and construction made in accordance with this plan meet the requirements of any particular jurisdiction.

**SUMMARY**

SIZE: 226.5 SQ.FT.  
WIDTH: 20 FT.  
LENGTH: 20 FT.  
HEIGHT: 4 FT 6.25 IN  
LEVELS: ONE

FINAL CONSTRUCTION PLANS AND PERMIT PLANS MAY BE ALTERED TO REPRESENT BUILDING CODE REQUIREMENTS AND ON-SITE CONDITIONS.

#	DESCRIPTION	mm/dd/yy

PROJECT	
DecksGo Plan#18-46a	
DRAWING	
DECK FRAMING DETAILS	
DRAWN BY Richard Bergman	SCALE AS SHOWN
© decksgo.com All Rights Reserved	SHEET <b>A3.1</b>
DATE JAN 21, 2022	

**WAIVER**

The provisions and details contained in this document are based on the International Residential Code (IRC) and best building practices at the time of writing. Other prescriptive construction methods recommended meet or exceed the minimum requirements of the IRC. Where any differences exist between details in this documents and the IRC, provisions of the IRC shall apply. This document does not prevent the use of other construction techniques or materials. All construction and materials must be approved by the authority having jurisdiction. Every effort has been made to reflect the language and intent of the IRC. However, no assurance can be made that designs and construction made in accordance with this plan meet the requirements of any particular jurisdiction.

**SUMMARY**

SIZE: 226.5 SQ.FT.  
WIDTH: 20 FT.  
LENGTH: 20 FT.  
HEIGHT: 4 FT 6.25 IN  
LEVELS: ONE

FINAL CONSTRUCTION PLANS AND PERMIT PLANS MAY BE ALTERED TO REPRESENT BUILDING CODE REQUIREMENTS AND ON-SITE CONDITIONS.

#	DESCRIPTION	mm/dd/yy

PROJECT	
DecksGo Plan#18-46a	
DRAWING	
RAILING DETAILS	
DRAWN BY	SCALE
Richard Bergman	AS SHOWN
© decksgo.com	
All Rights Reserved	
DATE	SHEET
JAN 21, 2022	A3.2

**FASCIA:**  
1. FASCIA TO BE MITRE CUT AT 45 DEGREE ANGLE AT FRONT CORNERS.

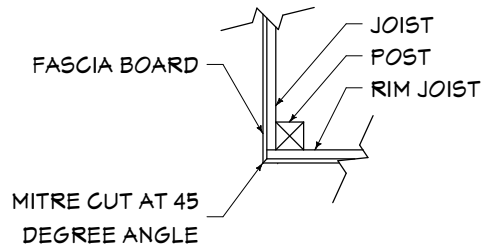

**HANDRAIL CAP:**  
1. HANDRAIL CAP TO BE 2X6, CENTERED ON RAILING POSTS  
2. HANDRAIL CAP TO BE MITRE-CUT AT 45 DEGREE ANGLES AT FRONT CORNERS

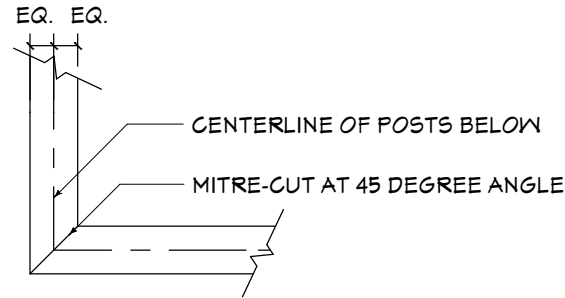

**DECK BOARDS:**  
1. SPACING BETWEEN DECK BOARDS TO BE 3/16" TO ALLOW FOR DRAINAGE AND MATERIAL EXPANSION.  
2. DECK BOARD SECTION DETAIL:

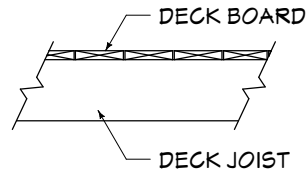

**RAILING POST:**  
1. RAILING POST TO BE ATTACHED TO OUTER JOIST USING 4 - 1/2" DIAMETER X 6" LONG (MIN.) BOLTS AND WASHERS  
2. FOR MORE CONNECTION OPTIONS, SEE [WWW.DECKSGO.COM/WOOD\\_DECK\\_RAILINGS](http://WWW.DECKSGO.COM/WOOD_DECK_RAILINGS)

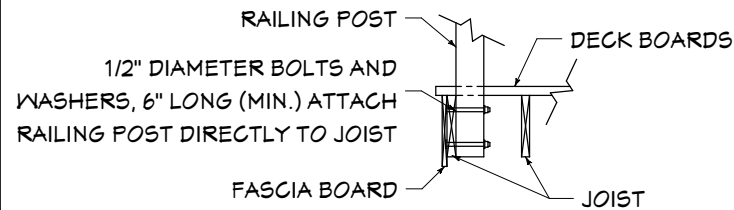

**01 FASCIA CORNER & DECK BOARD DETAILS**  
SCALE: 1/2"=1' 0"

**JOIST CONNECTED GUARD POST:**  
1. GUARD POST TO BE ATTACHED TO OUTER JOIST USING 1/2" DIAMETER X 8" LONG (MIN.) CARRIAGE BOLTS AND WASHERS

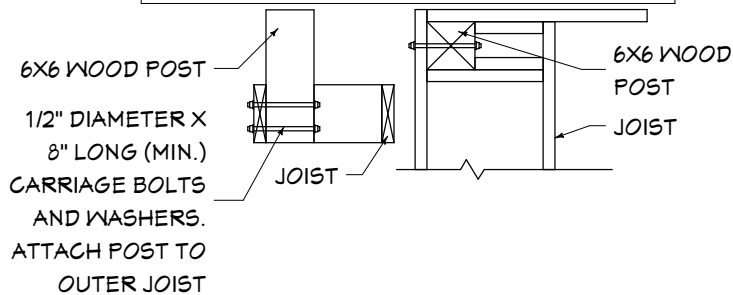

**02 GUARDRAIL CONNECTION DETAIL**  
SCALE: 1/2"=1' 0"

**BALUSTER AND TRIM:**  
1. TRIM TO BE 2X4s SECURED TO GUARDPOST AS PER DETAILS  
2. BALUSTERS TO BE 2X2s SECURED AS PER DETAILS  
3. OPENINGS BETWEEN BALUSTERS OR TRIM TO DECK BOARDS NOT TO EXCEED 4" MAX.

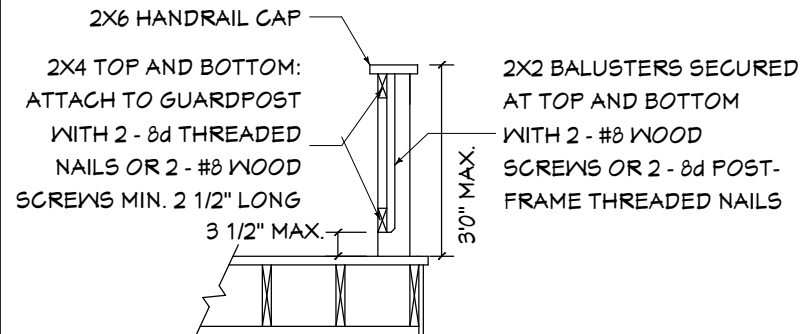

**03 RAILING DETAILS**  
SCALE: 1/2"=1' 0"

**STAIRS:**

1. MAXIMUM RISER HEIGHT TO BE NOT MORE THAN 7 3/4"
2. MINIMUM TREAD DEPTH TO BE NOT LESS THAN 10"
3. NOSING TO BE MIN 3/4" MAX. 1 1/4". NOSING SHALL NOT DEVIATE FROM ONE ANOTHER BY MORE THAN 3/8"

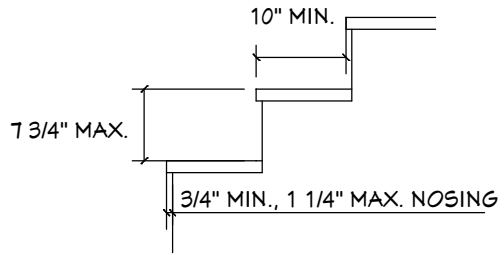

**STAIR STRINGER:**

1. STAIR STRINGER SHALL BE CONSTRUCTED OF 2X10 WOOD
2. MAXIMUM SPAN OF STAIR STRINGER TO BE 6'0". IF STRINGER EXCEEDS DIMENSIONS, ADDITIONAL 4X4 WOOD SUPPORT POST ON PROPER FOUNDATION REQUIRED
3. DISTANCE BETWEEN CUT STRINGERS TO BE NOT MORE THAN 18"

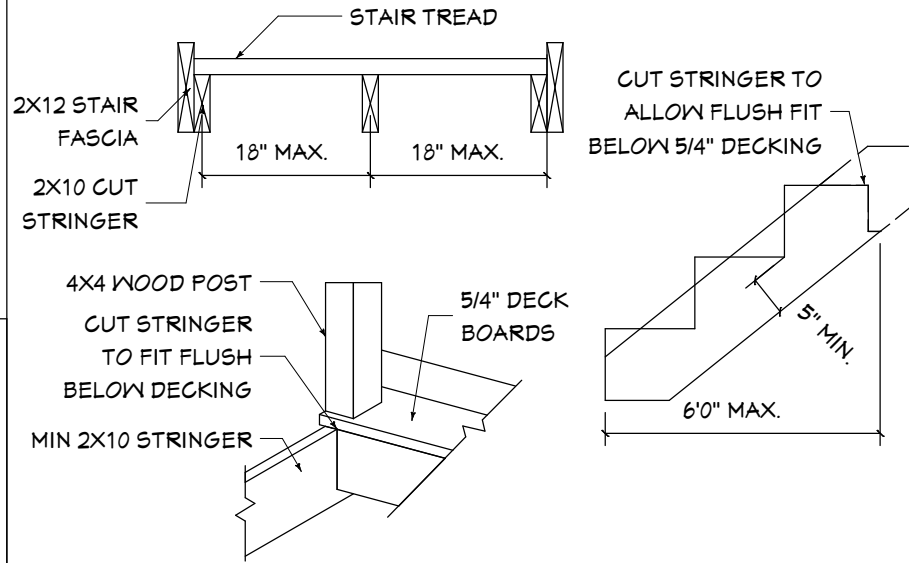

**STRINGER JOIST HANGER:**

1. ATTACH SLOPED JOIST HANGER FOR STRINGER DIRECTLY TO RIM JOIST OR OUTER JOIST

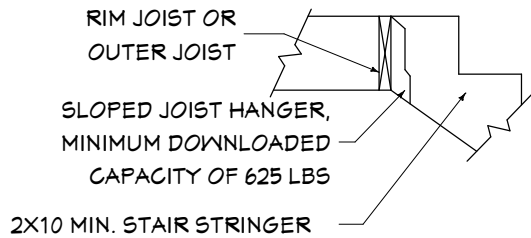

**STAIR GUARDRAIL:**

1. OPENINGS BETWEEN BALUSTERS OR TRIM TO DECK BOARDS NOT TO EXCEED 4" MAX.
2. GUARDRAIL, TRIM AND BALUSTERS AS PER TYPICAL

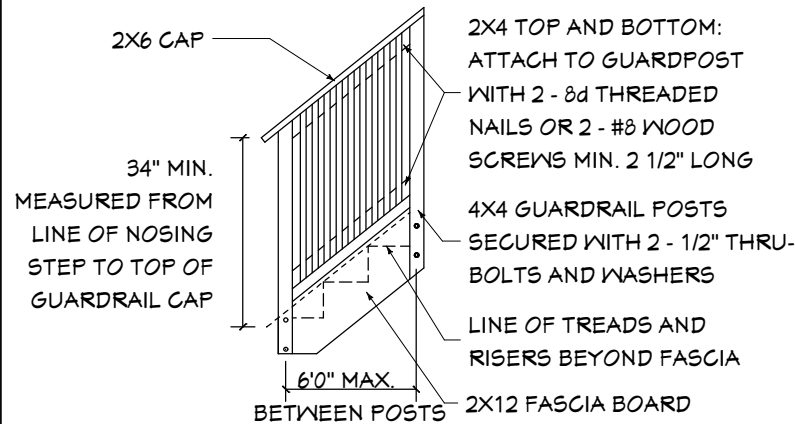

**SURFACE MOUNTED GUARD POST BLOCKING:**

1. GUARD POST TO BE ATTACHED TO DECK STRUCTURE USING TITAN WOOD POST ANCHOR - SEE ATTACHED INSTALLATION GUIDE

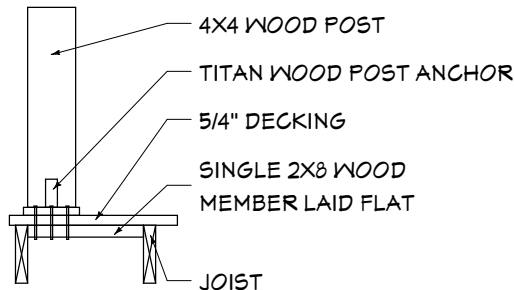

www.decksgo.com  
Toll: 1-844-833-3257

USA  
808 Commerce Park Drive, Unit 16348  
Ogdensburg, NY 13669

CAN  
5390 Canotek Road, Unit 14  
Ottawa, ON K1J 1H8

**WAIVER**

The provisions and details contained in this document are based on the International Residential Code (IRC) and best building practices at the time of writing. Other prescriptive construction methods recommended meet or exceed the minimum requirements of the IRC. Where any differences exist between details in this documents and the IRC, provisions of the IRC shall apply. This document does not prevent the use of other construction techniques or materials. All construction and materials must be approved by the authority having jurisdiction. Every effort has been made to reflect the language and intent of the IRC. However, no assurance can be made that designs and construction made in accordance with this plan meet the requirements of any particular jurisdiction.

**SUMMARY**

SIZE: 226.5 SQ.FT.  
WIDTH: 20 FT.  
LENGTH: 20 FT.  
HEIGHT: 4 FT 6.25 IN  
LEVELS: ONE

FINAL CONSTRUCTION PLANS AND PERMIT PLANS MAY BE ALTERED TO REPRESENT BUILDING CODE REQUIREMENTS AND ON-SITE CONDITIONS.

#	DESCRIPTION	mm/dd/yy

**PROJECT**

DecksGo Plan#18-46a

**DRAWING**

STAIR GUARDRAIL  
DETAILS

**DRAWN BY**

Richard Bergman

© decksgo.com  
All Rights Reserved

DATE

JAN 21, 2022

SCALE

SHEET

**A3.3**

OPTIONAL BALUSTER ATTACHMENT DETAIL:  
1. SEE ATTACHED INSTRUCTIONS

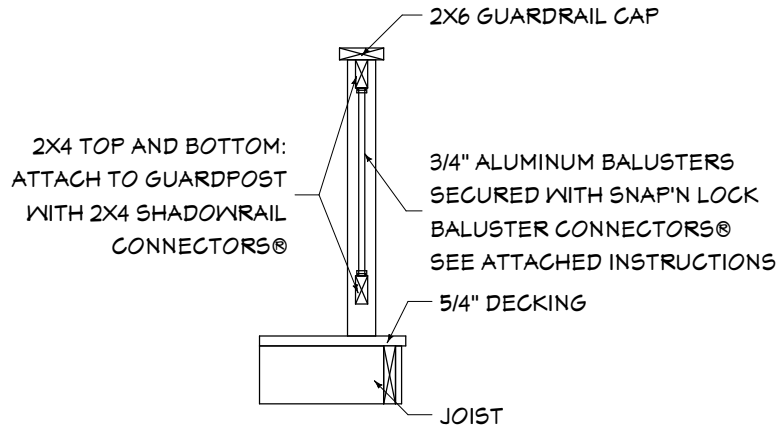

OPTIONAL RAIL ATTACHMENT DETAIL:  
1. SEE ATTACHED INSTRUCTIONS

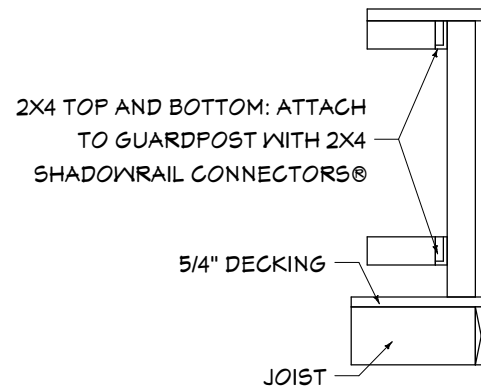

www.decksgo.com  
Toll: 1-844-833-3257

USA  
808 Commerce Park Drive, Unit 16348  
Ogdensburg, NY 13669

CAN  
5390 Canotek Road, Unit 14  
Ottawa, ON K1J 1H8

**WAIVER**

The provisions and details contained in this document are based on the International Residential Code (IRC) and best building practices at the time of writing. Other prescriptive construction methods recommended meet or exceed the minimum requirements of the IRC. Where any differences exist between details in this documents and the IRC, provisions of the IRC shall apply. This document does not prevent the use of other construction techniques or materials. All construction and materials must be approved by the authority having jurisdiction. Every effort has been made to reflect the language and intent of the IRC. However, no assurance can be made that designs and construction made in accordance with this plan meet the requirements of any particular jurisdiction.

**01** OPTIONAL ATTACHMENT DETAILS  
**A3.4** SCALE: 1/2"=1' 0"

**DIAGONAL BRACING:**

1. IF HEIGHT OF DECK IS TO BE GREATER THAN 2' ABOVE GRADE, 2X4 WOOD DIAGONAL BRACING IS TO BE USED
2. DIAGONAL 2X4 TO BE ATTACHED USING 3/8" DIAMETER X 8" LONG (MIN.) BOLTS WITH WASHERS

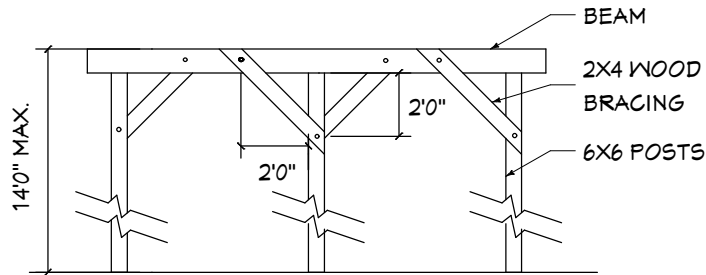

**BOARD ON BOARD PRIVACY FENCE:**

1. TOP AND BOTTOM RAIL ATTACHED TO 6X6 POST USING SHADOW RAIL CONNECTOR LEVEL - SEE ATTACHED INSTALLATION GUIDE

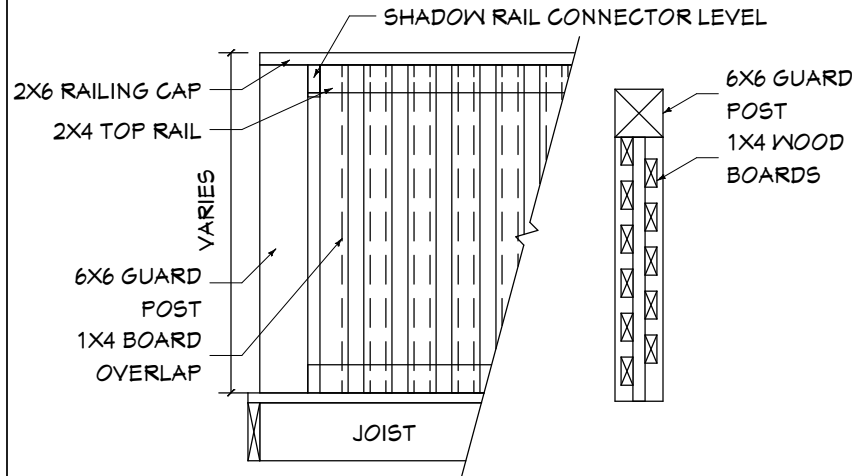

**SUMMARY**

SIZE: 226.5 SQ.FT.  
WIDTH: 20 FT.  
LENGTH: 20 FT.  
HEIGHT: 4 FT 6.25 IN  
LEVELS: ONE

FINAL CONSTRUCTION PLANS AND PERMIT PLANS MAY BE ALTERED TO REPRESENT BUILDING CODE REQUIREMENTS AND ON-SITE CONDITIONS.

#	DESCRIPTION	mm/dd/yy

**02** DIAGONAL BRACING DETAIL  
**A3.4** SCALE: 1/2"=1' 0"

**03** PRIVACY FENCE DETAILS  
**A3.4** SCALE: 1/2"=1' 0"

PROJECT  
**DecksGo Plan#18-46a**

DRAWING  
**OPTIONAL ATTACHMENT DETAILS**

DRAWN BY  
Richard Bergman

SCALE

© decksgo.com  
All Rights Reserved

DATE  
JAN 21, 2022

SHEET  
**A3.4**

**WAIVER**

The provisions and details contained in this document are based on the International Residential Code (IRC) and best building practices at the time of writing. Other prescriptive construction methods recommended meet or exceed the minimum requirements of the IRC. Where any differences exist between details in this documents and the IRC, provisions of the IRC shall apply. This document does not prevent the use of other construction techniques or materials. All construction and materials must be approved by the authority having jurisdiction. Every effort has been made to reflect the language and intent of the IRC. However, no assurance can be made that designs and construction made in accordance with this plan meet the requirements of any particular jurisdiction.

**SUMMARY**

SIZE: 226.5 SQ.FT.  
WIDTH: 20 FT.  
LENGTH: 20 FT.  
HEIGHT: 4 FT 6.25 IN  
LEVELS: ONE

FINAL CONSTRUCTION PLANS AND PERMIT PLANS MAY BE ALTERED TO REPRESENT BUILDING CODE REQUIREMENTS AND ON-SITE CONDITIONS.

#	DESCRIPTION	mm/dd/yy

PROJECT  
**DecksGo Plan#18-46a**

DRAWING  
**BENCH DETAIL**

DRAWN BY Richard Bergman	SCALE
© decksgo.com All Rights Reserved	SHEET <b>A3.5</b>
DATE JAN 21, 2022	

2X4 TOP BOARDS  
2X4 EDGE FINISH

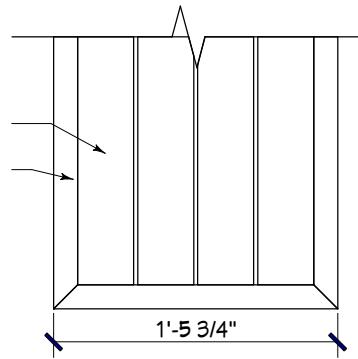

PLAN VIEW

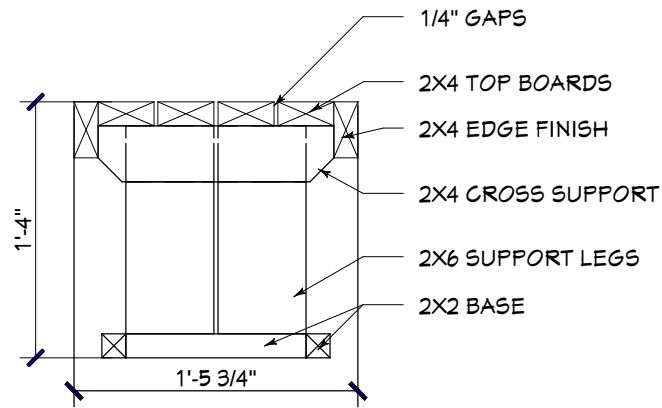

SECTION VIEW

2X4 EDGE FINISH

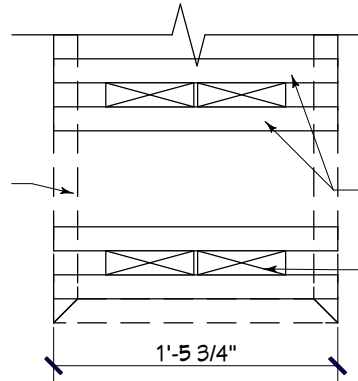

PLAN VIEW

2X4 CROSS SUPPORT  
2X6 SUPPORT LEGS

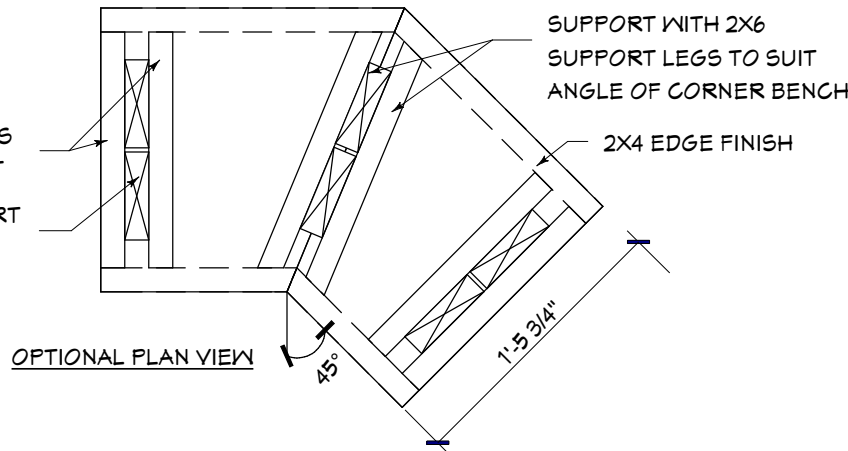

OPTIONAL PLAN VIEW

ADDITIONAL 2X4 CROSS SUPPORT WITH 2X6 SUPPORT LEGS TO SUIT ANGLE OF CORNER BENCH

2X4 CROSS SUPPORT  
2X6 SUPPORT LEGS

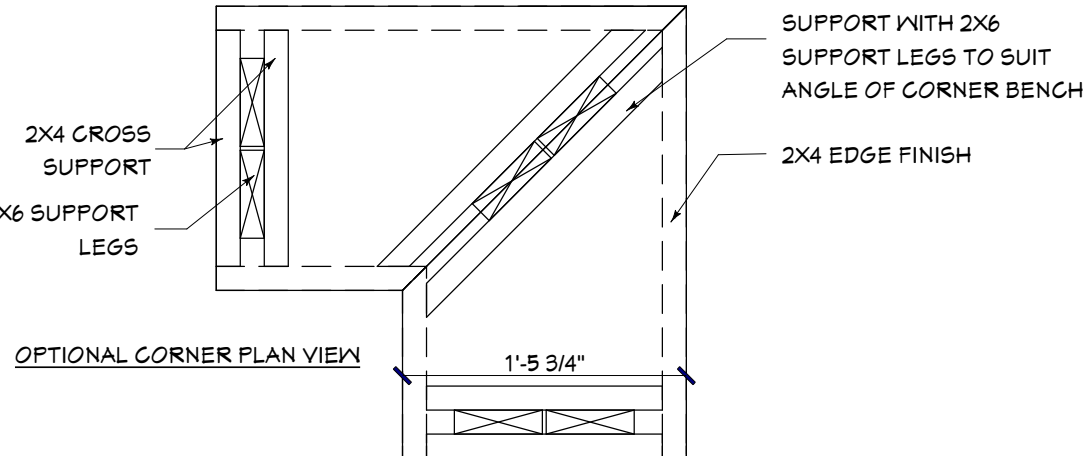

OPTIONAL CORNER PLAN VIEW

ADDITIONAL 2X4 CROSS SUPPORT WITH 2X6 SUPPORT LEGS TO SUIT ANGLE OF CORNER BENCH

**MATERIAL LIST - PRESSURE TREATED PINE\*\*\***

	DIMENSIONS	LENGTHS	QUANTITY	UNIT COST(Lin. FT)	PURPOSE	
POSTS:	6x6	VARIABLE**	13	\$5.50	VERTICAL STRUCTURE - DECK	
	4x4	3 FT	12	\$1.95	VERTICAL STRUCTURE - RAILING	
LUMBER:	2x8	14 FT 6 IN	2	\$1.95	BEAMS	
		11 FT 6 IN	2	\$1.95	BEAMS	
		10 FT 8 IN	2	\$1.95	BEAMS	
		7 FT 10 IN	2	\$1.95	BEAMS	
		5 FT 2 IN	2	\$1.95	BEAMS	
		18 FT 10 IN	1	\$1.95	CURVED RIM BOARD	
		15 FT 7 IN	1	\$1.95	RIM BOARD	
		15 FT 4 IN	1	\$1.95	RIM BOARD	
		14 FT 4 IN	1	\$1.95	JOISTS	
		14 FT 3 IN	1	\$1.95	JOISTS	
		12 FT 11 IN	1	\$1.95	JOISTS	
		12 FT 3 IN	1	\$1.95	JOISTS	
		11 FT 9 IN	1	\$1.95	JOISTS	
		11 FT 7 IN	1	\$1.95	JOISTS	
		10 FT 8 IN	1	\$1.95	JOISTS	
		10 FT 3 IN	1	\$1.95	JOISTS	
		9 FT 8 IN	1	\$1.95	JOISTS	
		9 FT	2	\$1.95	RIM BOARD/ JOISTS	
		8 FT 11 IN	1	\$1.95	JOISTS	
		8 FT 5 IN	1	\$1.95	JOISTS	
		8 FT	3	\$1.95	RIM BOARD/ JOISTS	
		7 FT 10 IN	1	\$1.95	JOISTS	
		5/4X6	VARIABLE**	43	\$1.40	DECK BOARDS
		2x6	15 FT 4 IN	1	\$1.522	RAILING CAPS
			9 FT	2	\$1.522	RAILING CAPS
		2x4	4 FT	2	\$1.522	RAILING CAPS
			15 FT 4 IN	2	\$1.07	HORIZONTAL RAILING SUPPORT
			9 FT	4	\$1.07	HORIZONTAL RAILING SUPPORT
1x10	4 FT	4	\$1.07	HORIZONTAL RAILING SUPPORT		
	15 FT 4 IN	1	\$2.00	FASCIA		
	9 FT	2	\$2.00	FASCIA		
	4 FT	2	\$2.00	FASCIA		

\*VALUES NOTED ABOVE ARE ESTIMATES ONLY. ESTIMATE DOES NOT INCLUDE MATERIAL NEEDED FOR BLOCKING FOR DIAGONAL SUPPORTS ON POSTS

\*\*VARIABLE LENGTHS OF MATERIALS DEPEND ON SITE FACTORS SUCH AS HEIGHT OF DECK FROM GRADE LEVEL, PERMITTED HEIGHT OF PRIVACY FENCE, ETC.

\*\*\*THE ABOVE COST ESTIMATE IS BASED ON AN AVERAGE OF PRICING SAMPLED FROM ACROSS THE COUNTRY FOR EACH MATERIAL. IT IS INTENDED AS A GENERAL ESTIMATE ONLY. YOU MAY FIND LOCAL PRICES THAT ARE HIGHER OR LOWER.

COST CALCULATIONS FOR ALL DECKS INCLUDE A PRESSURE TREATED SUBSTRUCTURE OF TREATED PINE (SUPPORT POSTS, BEAMS, JOISTS) DECK BOARD AND FASCIA COSTS ARE BASED ON THE MATERIAL SPECIFIED. COSTS FOR RAILINGS, PRIVACY PANELS, FOUNDATION AND RELATED HARDWARE ARE NOT INCLUDED DUE TO THE VARIABILITY OF MATERIAL SELECTION.

Deck's Go - Materials available online		
Material	Website info.	Quantity
Post anchor (4X4)	<a href="#">Click Here Now To Order</a>	12
Post anchor (6X6)	<a href="#">Click Here Now To Order</a>	-
Post Skirt	<a href="#">Click Here Now To Order</a>	12
Shadow Rail level	<a href="#">Click Here Now To Order</a>	18
Shadow Rail Stair	<a href="#">Click Here Now To Order</a>	8
Snap'n Lock	<a href="#">Click Here Now To Order</a>	12 kits 6 stair kits

Deck's Go - Materials available online		
Material	Website info.	Quantity
Post Cap	<a href="#">Click Here Now To Order</a>	12
Deck Foot	<a href="#">Click Here Now To Order</a>	13
Structural Post Anchor	<a href="#">Click Here Now To Order</a>	-
Wood Install kit	<a href="#">Click Here Now To Order</a>	-

**Pricing for Deck 18-46a (USD):**

Type	Length (FT)	Quantity	Cost (lin.ft.)	Total
<b>Posts</b>				<b>\$141.70</b>
6x6	1	13	\$5.50	\$71.50
4x4	3	12	\$1.95	\$70.20
<b>Beams</b>				<b>\$193.71</b>
2x8	14.5	2	\$1.95	\$56.55
	11.5	2	\$1.95	\$44.85
	10.67	2	\$1.95	\$41.61
	7.83	2	\$1.95	\$30.54
	5.17	2	\$1.95	\$20.16
<b>Joists</b>				<b>\$437.93</b>
2x8	18.83	1	\$1.95	\$36.72
	15.58	1	\$1.95	\$30.38
	15.33	1	\$1.95	\$29.89
	14.33	1	\$1.95	\$27.94
	14.25	1	\$1.95	\$27.79
	12.92	1	\$1.95	\$25.19
	12.25	1	\$1.95	\$23.89
	11.75	1	\$1.95	\$22.91
	11.58	1	\$1.95	\$22.58
	10.67	1	\$1.95	\$20.81
	10.25	1	\$1.95	\$19.99
	9.67	1	\$1.95	\$18.86
	9	2	\$1.95	\$35.10
	8.92	1	\$1.95	\$17.39
	8.42	1	\$1.95	\$16.42
	8	3	\$1.95	\$46.80
	7.83	1	\$1.95	\$15.27
<b>Railing Caps</b>				<b>\$62.90</b>
2x6	15.33	1	\$1.522	\$23.33
	9	2	\$1.522	\$27.40
	4	2	\$1.522	\$12.18
<b>Horizontal Railing Support</b>				<b>\$88.45</b>
2x4	15.33	2	\$1.07	\$32.81
	9	4	\$1.07	\$38.52
	4	4	\$1.07	\$17.12
<b>Fascia</b>				<b>\$82.66</b>
1x10	15.33	1	\$2.00	\$30.66
	9	2	\$2.00	\$36.00
	4	2	\$2.00	\$16.00
			<b>Total</b>	<b>\$1,007.35</b>

Deck Boards	\$/Sq.Ft.					
Sq.Ft.	PTP	Cedar	Redwood	Composite	PVC	Exotic
226.5	\$2.80	\$4.04	\$6.90	\$8.00	\$8.90	\$9.70
<b>Total:</b>	<b>\$634.20</b>	<b>\$915.06</b>	<b>\$1,562.85</b>	<b>\$1,812.00</b>	<b>\$2,015.85</b>	<b>\$2,197.05</b>



www.decksgo.com  
Toll: 1-844-833-3257

USA  
808 Commerce Park Drive, Unit 16348  
Ogdensburg, NY 13669

CAN  
5390 Canotek Road, Unit 14  
Ottawa, ON K1J 1H8

**WAIVER**

The provisions and details contained in this document are based on the International Residential Code (IRC) and best building practices at the time of writing. Other prescriptive construction methods recommended meet or exceed the minimum requirements of the IRC. Where any differences exist between details in this document and the IRC, provisions of the IRC shall apply. This document does not prevent the use of other construction techniques or materials. All construction and materials must be approved by the authority having jurisdiction. Every effort has been made to reflect the language and intent of the IRC. However, no assurance can be made that designs and construction made in accordance with this plan meet the requirements of any particular jurisdiction.

**SUMMARY**

SIZE: 226.5 SQ.FT.  
WIDTH: 20 FT.  
LENGTH: 20 FT.  
HEIGHT: 4 FT 6.25 IN  
LEVELS: ONE

FINAL CONSTRUCTION PLANS AND PERMIT PLANS MAY BE ALTERED TO REPRESENT BUILDING CODE REQUIREMENTS AND ON-SITE CONDITIONS.

#	DESCRIPTION	mm/dd/yy

**PROJECT**

DecksGo Plan#18-46a

**DRAWING**

**MATERIAL LIST**

DRAWN BY  
Richard Bergman

© decksgo.com  
All Rights Reserved

DATE  
JAN 21, 2022

SCALE

SHEET

**A4.0**

# INSTALLATION | DECK FOOT ANCHOR™

## IMPORTANT NOTE :



CHECK YOUR LOCAL BUILDING DEPARTMENT FOR HEIGHT REQUIREMENTS REGARDING FREE STANDING STRUCTURES.

**1** Remove Sod and any organic material. Add 2" – 3" of 1/2" Crushed Stone or Stone Dust Base

**DECK FOOT ANCHOR™**

TOOLS NEEDED:

- 350 FT.-LBS. ELECTRIC CORDED 1/2" IMPACT WRENCH
- 12 MM AND 24 MM, 6 POINT DEEP IMPACT SOCKET
- 12 POINT SOCKET
- 1/2"

1/4 x 3" lag screws sold separately.

**2**

NUT  
LOAD PLATE  
AUGER  
Assemble parts.

**3**

Drive Anchor down.

**4**

STOP when plate contacts ground and the nut contacts top of plate.

**5**

Use 24 mm socket and compress plate against top of washer.

**6**

Install bracket, washer and nut.

Make side-to-side fine adjustments before fastening.

**7**

Install screw at bottom of each hole. Stop as soon as screw contacts bracket.

**HOUSE**

BEAM SPAN  
JOIST SPAN

6'-0" max.  
6'-0" max.  
6'-0" max.  
6'-0" max.  
6'-0" max.  
6'-0" max.

WE RECOMMEND ADDING ONE MORE FOOTING TO INNER BEAMS.

**FOOTING LAYOUT GUIDE**

ASSUMES 1800 PSF SOIL

For 1500 psf soil, 5'-6" center to center max. spacing  
Maximum Joist cantilever 24"  
Maximum Beam cantilever 24"

Joists on beam

Hanging joists

As low as 2" above grade

Post / Beam / Joist Bracing

6'-0" max recommended

\* Check local codes for height restrictions for free standing structures.

Optional Deck Frame Bracing

## TITAN DECK FOOT ANCHOR™ / TIDP442 / TIDP662 / TIDKP / TIGA600 / TIGA900

PATENT NO US 9,309,688

ATTENTION: Before beginning work, consult with local building officials or engage professionals to ensure that this product is appropriate for your intended use or help clarify if these warnings are unclear or if you do not understand any of the information in this installation guide. Always comply with applicable building codes and be advised that building codes may vary.

ADVERTENCIA : Antes de comenzar a trabajar, consulte con funcionarios de la construcción local o contrate profesionales para asegurarse de que este producto sea apropiado para la aplicación deseada o para para ayudar a clarificar en caso de que estas advertencias no sean claras o en caso de que usted no comprenda parte de la información de esta guía de instalación. Siempre cumpla con los códigos de construcción aplicables y sepa que los códigos de la construcción pueden variar.

ATTENTION : Avant de commencer le travail, consultez les autorités locales en construction ou embauchez des professionnels pour assure que ce produit est approprié pour l'application que vous avez en vue ou pour aider à clarifier ces instructions si elles ne sont pas claires ou si vous ne comprenez pas quelque information que ce soit dans ce guide d'installation. Conformez vous toujours aux codes du bâtiment qui s'appliquent à sachez que les codes du bâtiment peuvent varier d'un endroit à un autre.

IN NO EVENT SHALL TITAN BUILDING PRODUCTS BE LIABLE FOR ANY LOSS OR DAMAGE, DIRECT OR OTHERWISE, WHICH RESULTS FROM THE IMPROPER INSTALLATION OR USE OF THIS PRODUCT. IF FOR ANY REASON TITAN BUILDING PRODUCTS BECOMES LIABLE FOR LOSS OR DAMAGE, DIRECT OR OTHERWISE, THE AGGREGATE LIABILITY OF TITAN BUILDING PRODUCTS SHALL BE LIMITED TO THE RETAIL PURCHASE PRICE OF THE PRODUCTS.

QUESTIONS? CONTACT US TOLL FREE  
**1-866-577-8868**



titanbuildingproducts.com



# INSTALLATION | DECK FOOT ANCHOR™

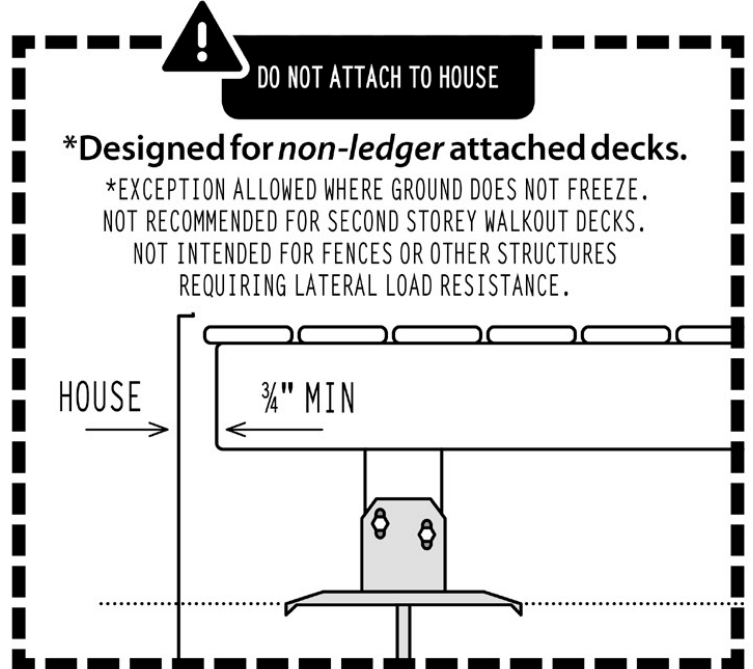
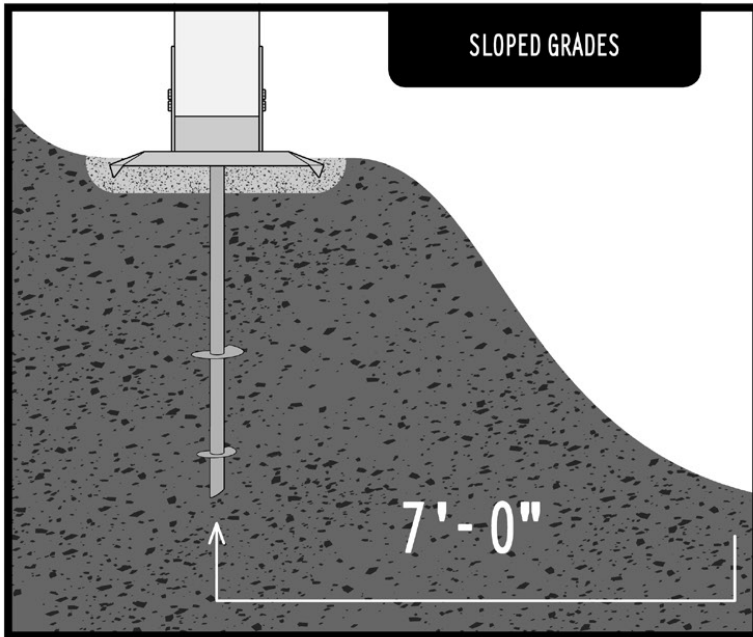

## Introducing *Terra-Shift™*

“A SHOCK ABSORBER SYSTEM FOR YOUR DECK”

The Titan Deck Foot Anchor™ uses our patented *Terra-Shift™* post bracket system to help keep soil around the anchor undisturbed and prevent damage to all post and beam and other structural connections.

### TERRA-SHIFT™ Technology

Here is how it works:

The fastener slide holes reduce friction between the

post and bracket just enough so that if the soil shifts or expands unevenly along a series of footings under a beam, the post is free to slide vertically and then settle back to normal. It's like a shock absorbing system for your deck.

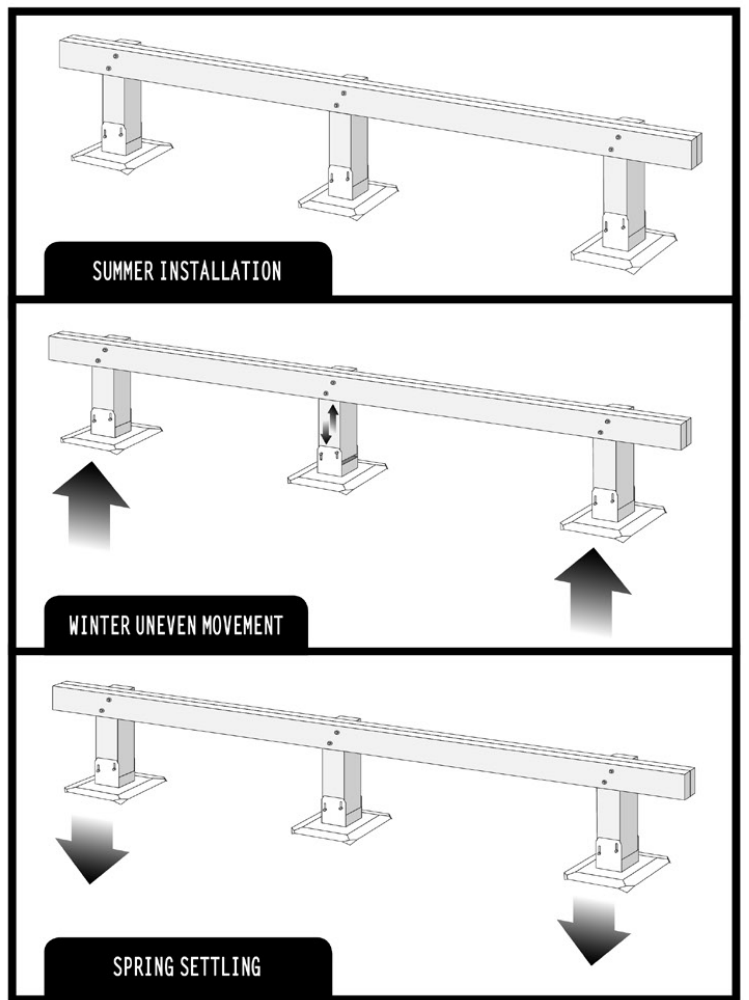
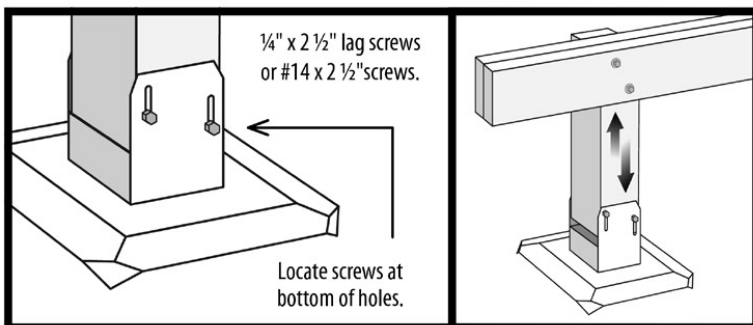

TITAN DECK FOOT ANCHOR™ / TIDP442 / TIDP662 / TIDKP / TIGA600 / TIGA900

PATENT NO US 9,309,688

ATTENTION: Before beginning work, consult with local building officials or engage professionals to ensure that this product is appropriate for your intended use or help clarify if these warnings are unclear or if you do not understand any of the information in this installation guide. Always comply with applicable building codes and be advised that building codes may vary.

ADVERTENCIA : Antes de comenzar a trabajar, consulte con funcionarios de la construcción local o contrate profesionales para asegurarse de que este producto sea apropiado para la aplicación deseada o para para ayudar a clarificar en caso de que estas advertencias no sean claras o en caso de que usted no comprenda parte de la información de esta guía de instalación. Siempre cumpla con los códigos de construcción aplicables y sepa que los códigos de la construcción pueden variar.

ATTENTION : Avant de commencer le travail, consultez les autorités locales en construction ou embauchez des professionnels pour assure que ce produit est approprié pour l'application que vous avez en vue ou pour aider à clarifier ces instructions si elles ne sont pas claires ou si vous ne comprenez pas quelque information que ce soit dans ce guide d'installation. Conformez vous toujours aux codes du bâtiment qui s'appliquent à sachez que les codes du bâtiment peuvent varier d'un endroit à un autre.

**QUESTIONS? CONTACT US AT 1-866-577-8868** IN NO EVENT SHALL TITAN BUILDING PRODUCTS BE LIABLE FOR ANY LOSS OR DAMAGE, DIRECT OR OTHERWISE, WHICH RESULTS FROM THE IMPROPER INSTALLATION OR USE OF THIS PRODUCT. IF FOR ANY REASON TITAN BUILDING PRODUCTS BECOMES LIABLE FOR LOSS OR DAMAGE, DIRECT OR OTHERWISE, THE AGGREGATE LIABILITY OF TITAN BUILDING PRODUCTS SHALL BE LIMITED TO THE RETAIL PURCHASE PRICE OF THE PRODUCTS.

QUESTIONS? CONTACT US TOLL FREE

**1-866-577-8868**



titanbuildingproducts.com



# INSTALLATION | COMPRESSION POST BASE KIT 4x4 / 4x6 / 6x6

## IMPORTANT NOTE



FOR COMPRESSION LOADS ONLY WHERE TOP OF POST IS CONNECTED TO AN UPPER STRUCTURE. NOT INTENDED FOR USE IN GUARD RAILS.

### COMPRESSION POST BASE KIT

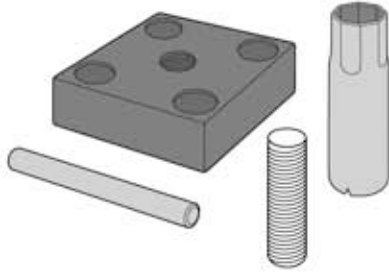

(1) Base, (1) Tube, (1) Locking pin, (1) Threaded Stud  
Concrete screws sold separately.

### TOOLS NEEDED

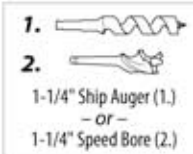

**1** **START**

BORE 1-1/4" diameter hole to 4-1/4" deep.

**2**

TAP tube into bore with V-CUT facing side of post.

**3**

Insert threaded stud into nut inside tube.

Using a scrap of wood, TAP stud to set tube 1/16" to 1/8" below surface of post.

1/16" - 1/8"

TAP tube flush with bottom of post.

**4**

MARK locking pin hole location in Center of post 3-1/2" from end of post.

**5**

DRILL with 3/8" speed bit to the opposite side of post.

**6**

TAP locking pin into hole and set it 1/8" inside of post.

TITAN COMPRESSION POST BASE™ KIT / TICP44 / TICP46 / TICP66

QUESTIONS? CONTACT US TOLL FREE

**1-866-577-8868**



titanbuildingproducts.com



# INSTALLATION | COMPRESSION POST BASE KIT 4x4 / 4x6 / 6x6

## IMPORTANT NOTE



FOR COMPRESSION LOADS ONLY WHERE TOP OF POST IS CONNECTED TO AN UPPER STRUCTURE. NOT INTENDED FOR USE IN GUARD RAILS.

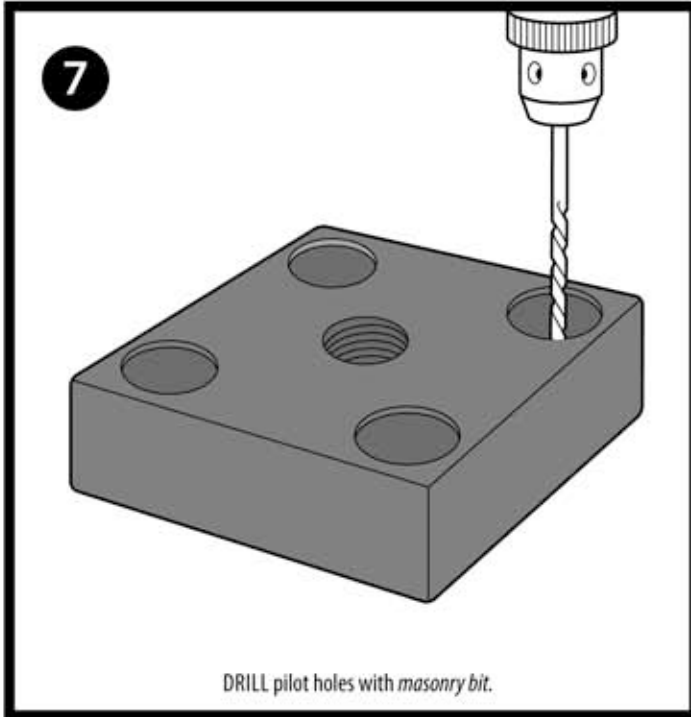

DRILL pilot holes with *masonry bit*.

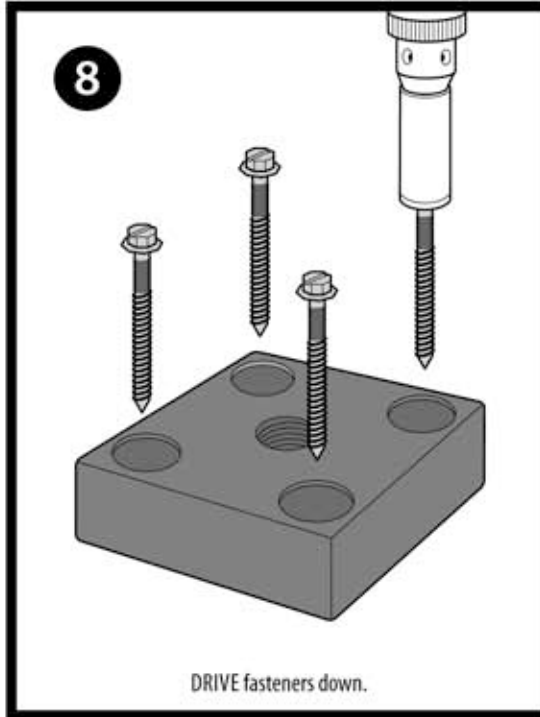

DRIVE fasteners down.

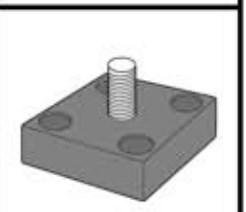
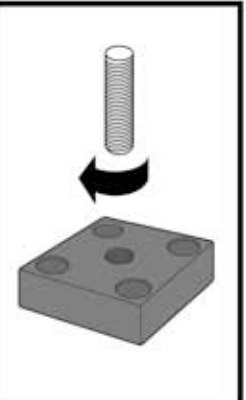

HAND TIGHTEN threaded stud until stud contacts substrate.

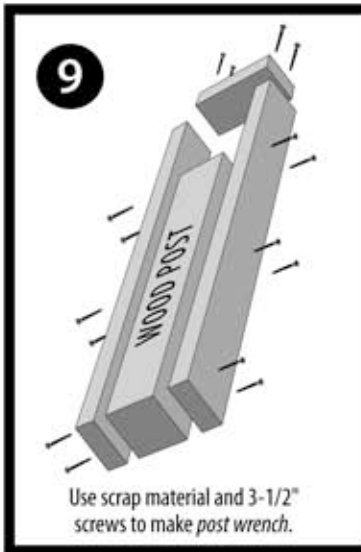

Use scrap material and 3-1/2" screws to make *post wrench*.

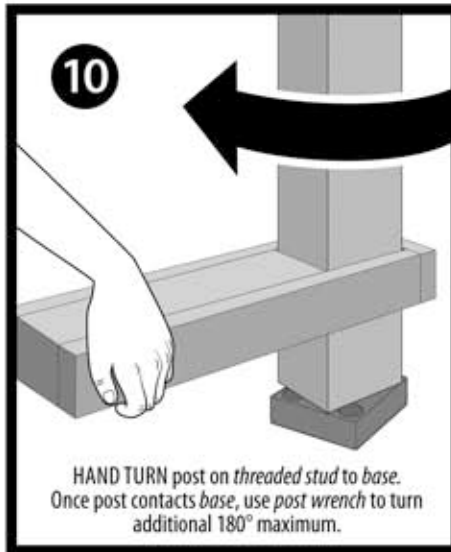

HAND TURN post on threaded stud to base. Once post contacts base, use *post wrench* to turn additional 180° maximum.

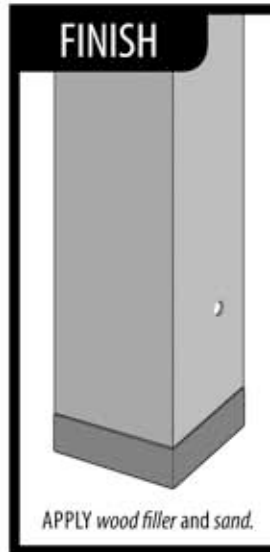

APPLY wood filler and sand.



## TITAN COMPRESSION POST BASE™ KIT / TICP44 / TICP46 / TICP66

PATENT NO

PENDING

IN NO EVENT SHALL TITAN BUILDING PRODUCTS BE LIABLE FOR ANY LOSS OR DAMAGE, DIRECT OR OTHERWISE, WHICH RESULTS FROM THE IMPROPER INSTALLATION OR USE OF THIS PRODUCT. IF FOR ANY REASON TITAN BUILDING PRODUCTS BECOMES LIABLE FOR LOSS OR DAMAGE, DIRECT OR OTHERWISE, THE AGGREGATE LIABILITY OF TITAN BUILDING PRODUCTS SHALL BE LIMITED TO THE RETAIL PURCHASE PRICE OF THE PRODUCTS.

QUESTIONS? CONTACT US TOLL FREE

**1-866-577-8868**



titanbuildingproducts.com



# SNAP N LOCK BALUSTER KIT™ | ENSEMBLE DE BARREAUX™ | KIT DE BALAUSTRE™

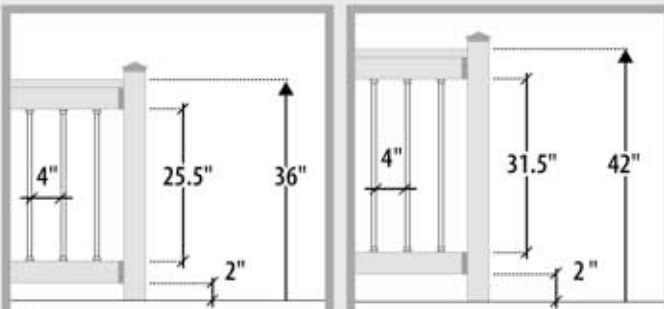

Maximum allowable Gap and space between Balusters is 4".	Espace maximal de 4 po entre chaque barreau.	La separación máxima permitida y el espacio entre los balaustres es de 4".
--	--	--

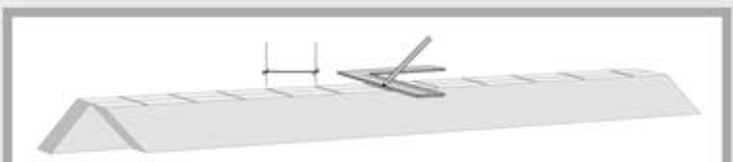

Invert rails as shown. Starting from the center of rails, mark lines at 5 1/2" on center.	Inversez les rails, tel qu'illustré. À partir du centre des rails, tracez une ligne à 5-1/2 po d'entraxe.	Invertir los rieles como se muestra. Partiendo del centro de los carriles, marque las líneas a 5 1/2" en el centro.
---	---	---



Starting from the center of rails, mark lines at 4-1/2" on center.	À partir du centre des rails, tracez une ligne à 4-1/2 po d'entraxe.	Desde el centro de los carriles, marque líneas en 4-1/2" en el centro.
--	--	--

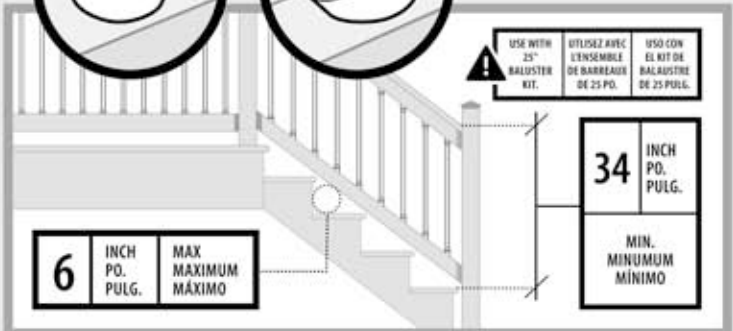
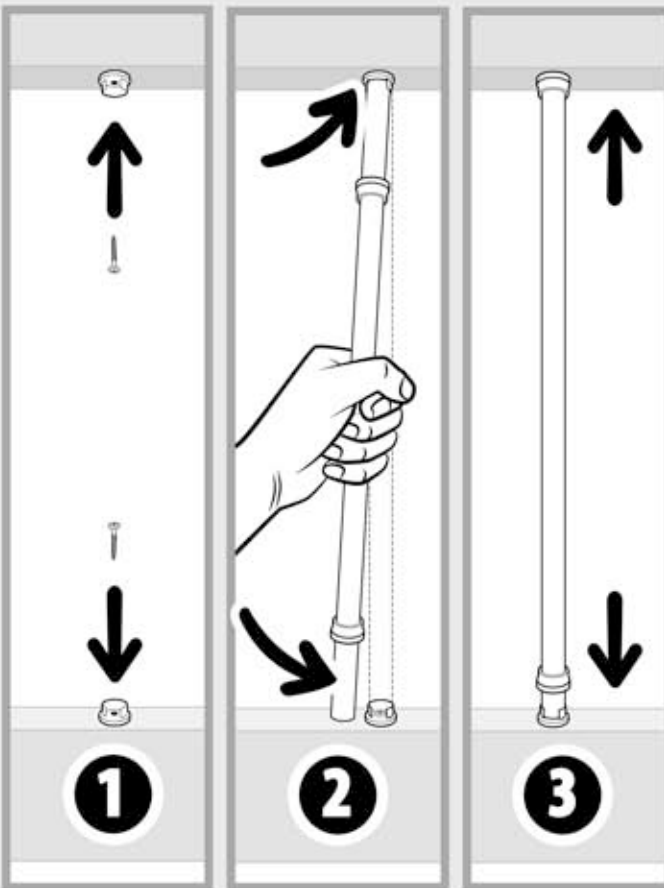
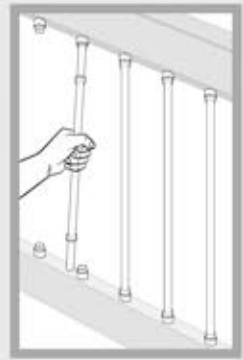
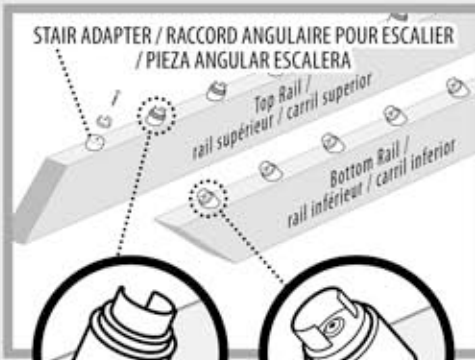

**ADD COLLARS, REPLACE WOOD BALUSTERS OR RE-STAIN RAILINGS, QUICKLY, ANYTIME WITH NO MESS OR RAILS TO DISMANTLE.**

**AJOUTEZ DES COLLIERS, REMPLACEZ RAPIDEMENT LES BARREAUX EN BOIS OU RETEIGNEZ-LES SANS DÉGÂTS SANS DÉSASSEMBLER LES GARDE-CORPS.**

**AGREGUE LOS COLLARES, REEMPLACE LOS BALAUSTRES DE MADERA O RE-MANCHA LOS BARANDALES, RÁPIDAMENTE, EN CUALQUIER MOMENTO SIN EL LÍO O LOS CARRILES PARA DESMONTAR.**

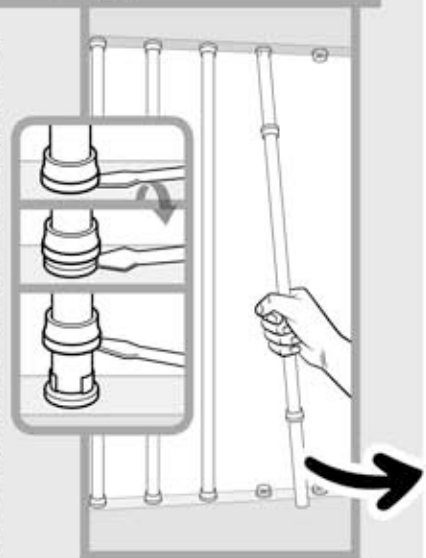

QUESTIONS? CONTACT US TOLL FREE  
**1-866-577-8868**



titanbuildingproducts.com

# 4x4/4x6 | SOFTWOOD | POST ANCHOR INSTALLATION

## IMPORTANT NOTE



USE ONLY STAINLESS STEEL SCREWS WITH ALUMINUM DECKING. SOLD SEPARATELY.

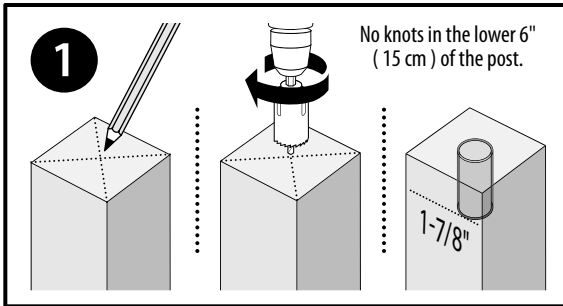

### TITAN POST ANCHOR™ KIT

- (1) Post Anchor
  - (8) \*Wood Screw #14 No. 3 Square Drive
  - (4) \*Lag Screw 3/8" X 5"
- ACQ**  
\*Concrete screws sold separately.

### RECOMMENDED TOOLS

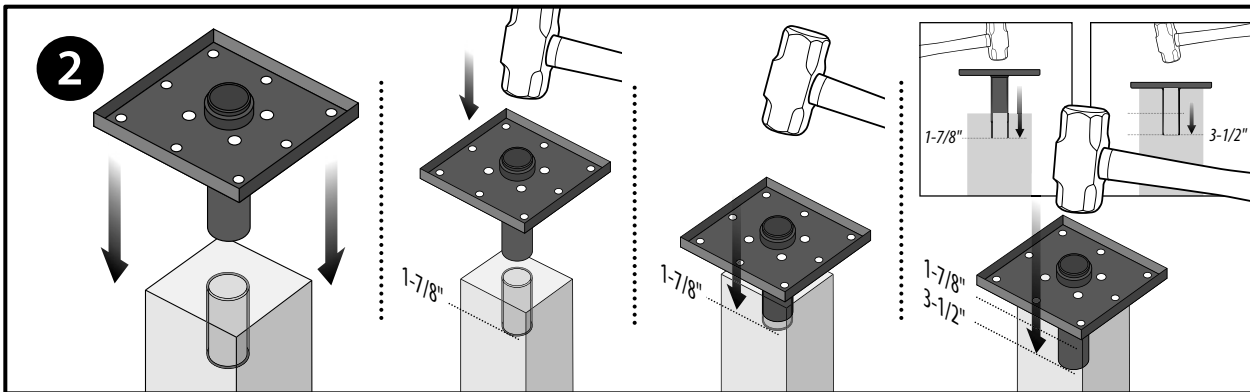
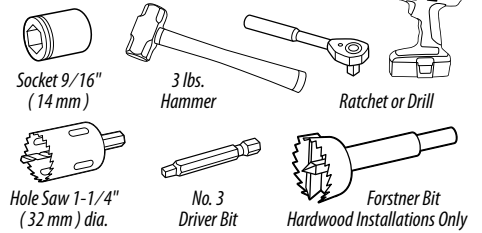

**FOR VERY DRY WOOD, WET ENDS OF POST WITH WATER BEFORE USE TO PREVENT CRACKING.**

### DRILL

#### LAG SCREW / DRILL BIT GUIDE

SOFTWOOD POST
3/8" LAG SCREW
5/16" DRILL BIT
1/2" LAG SCREW
7/16" DRILL BIT
HARDWOOD POST
3/8" LAG SCREW
11/32" DRILL BIT
1/2" LAG SCREW
15/32" DRILL BIT

#### DECK SCREW / DRILL GUIDE

HARDWOOD OR COMPOSITE DECKING
#14 OR 1/4" DECK SCREW
7/32" DRILL BIT

## THE INTERNATIONAL RESIDENTIAL CODE (IRC - USA) AND THE NATIONAL BUILDING CODE OF CANADA (NBC - CANADA)

### INSTALLING RESIDENTIAL GUARDS:

This product has been independently tested according to established AC 273 procedures set out in the IRC for the USA and NBC for Canada. It can be used as a code compliant post anchoring component in one and two family residential guard rail applications when installed according to these directions and conditions of use.

### MATERIALS:

Use SPF lumber for posts and double blocking between joists below each post. Attach top rail to posts in POST TO RAIL DETAIL - A or B.

### QUESTIONS? CONTACT US AT 1-866-577-8868

In no event shall Titan Building Products be liable for any loss or damage, direct or otherwise, which results from the improper installation or use of this product. If for any reason Titan Building Products becomes liable for loss or damage, direct or otherwise, the aggregate liability of Titan Building Products shall be limited to the retail purchase price of the products.

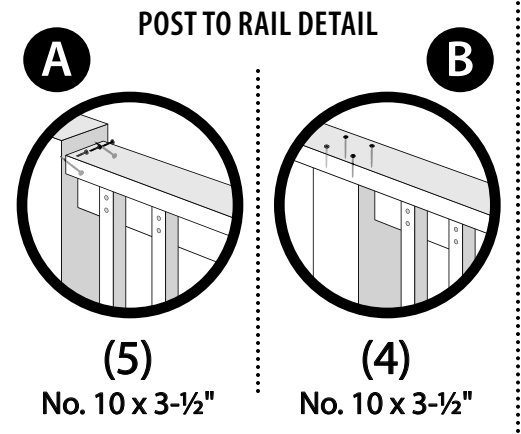

# 4x4/4x6 | HARDWOOD | POST ANCHOR INSTALLATION

## IMPORTANT NOTE

USE ONLY STAINLESS STEEL SCREWS WITH ALUMINUM DECKING. SOLD SEPARATELY.

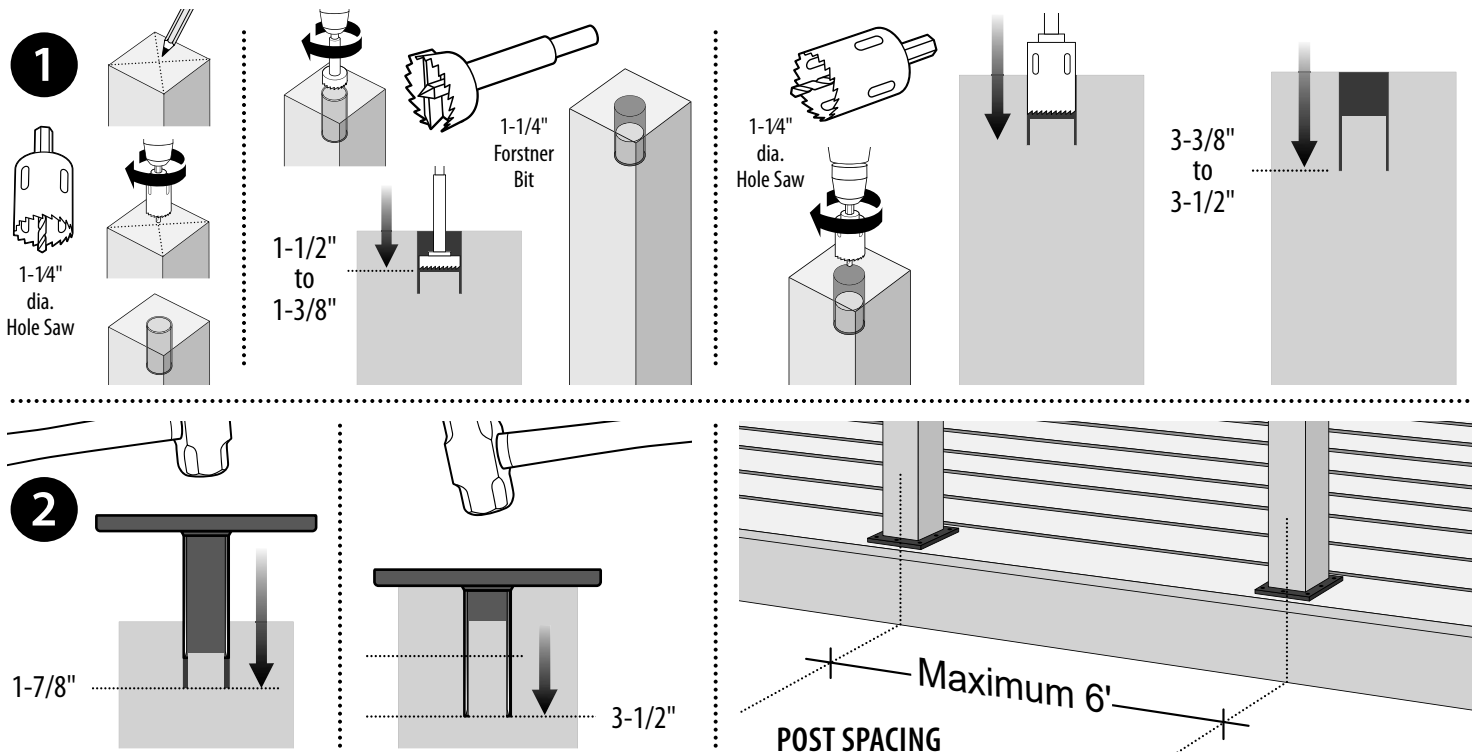

# 4x4/4x6 | CONCRETE | POST ANCHOR INSTALLATION

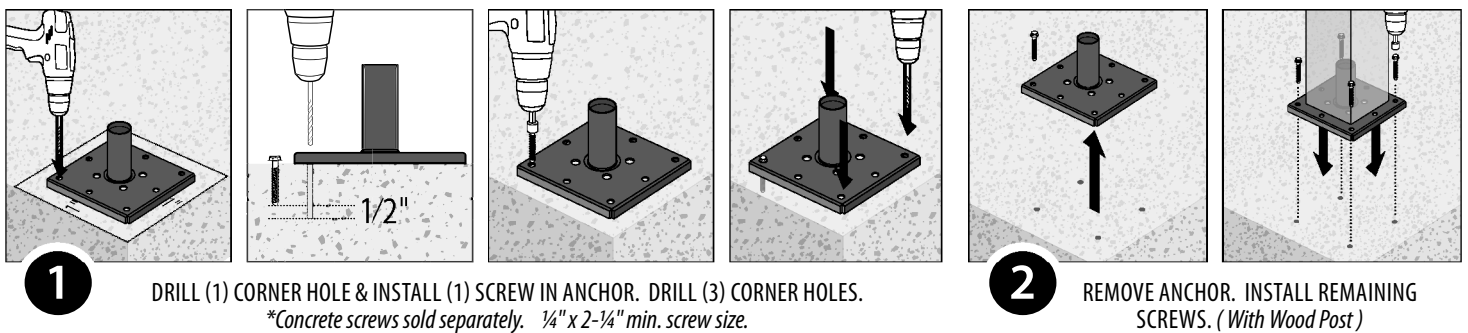

**ATTENTION:** Before beginning work, consult with local building officials or engage professionals to ensure that this product is appropriate for your intended use or help clarify if these warnings are unclear or if you do not understand any of the information in this installation guide. Always comply with applicable building codes and be advised that building codes may vary.

**ATTENTION:** Avant de commencer le travail, consultez les autorités locales en construction ou embauchez des professionnels pour assurer que ce produit est approprié pour l'application que vous avez en vue ou pour aider à clarifier ces instructions si elles ne sont pas claires ou si vous ne comprenez pas quelque information que ce soit dans ce guide d'installation. Conformez vous toujours aux codes du bâtiment qui s'appliquent à sachez que les codes du bâtiment peuvent varier d'un endroit à un autre.

**ADVERTENCIA:** Antes de comenzar a trabajar, consulte con funcionarios de la construcción local o contrate profesionales para asegurarse de que este producto sea apropiado para la aplicación deseada o para para ayudar a clarificar en caso de que estas advertencias no sean claras o en caso de que usted no comprenda parte de la información de esta guía de instalación. Siempre cumpla con los códigos de construcción aplicables y sepa que los códigos de la construcción pueden variar.

# INSTALLATION | STRUCTURAL WOOD POST ANCHOR KIT 4x4 / 6x6

USE ON CONCRETE, STONE AND COMPOSITE SURFACES.

FOR RAIL, FENCE, PERGOLA POSTS AND MORE.

## STRUCTURAL WOOD POST ANCHOR KIT



## TOOLS NEEDED

HAMMER



SOCKET



WOOD FILLER, SANDPAPER, PUTTY KNIFE



Wedge Bolts®



1/8" Allen Key

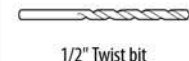

1/2" Twist bit



1-1/4" x 18" Ship Auger

OPTIONAL



Grease



POST WRENCH  
See step 10

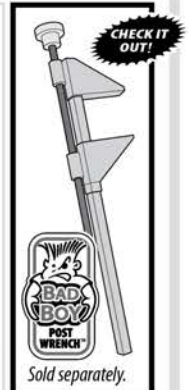

**1** **START**

BORE 1-1/4" diameter hole to 11-1/2" deep.

**2**

TAP tube into bore with V-CUT facing side of post.

**3**

Insert threaded stud into nut inside tube.

Using a scrap of wood, TAP stud to set tube 1/16" to 1/8" below surface of post.

1/16" - 1/8"

TAP tube flush with bottom of post.

**4**

MARK the 2 locking pin holes location in Center of post as shown.

**5**

DRILL with 1/2" Twist bit to the opposite side of post.

**6**

TAP the 2 locking pins into holes and set them 1/8" inside of post.

TITAN STRUCTURAL WOOD POST ANCHOR KIT / TSPA35 / TSPA55

QUESTIONS? CONTACT US TOLL FREE

**1-866-577-8868**



titanbuildingproducts.com



# INSTALLATION | STRUCTURAL WOOD POST ANCHOR KIT 4x4 / 6x6

USE ON CONCRETE, STONE AND COMPOSITE SURFACES.

FOR RAIL, FENCE, PERGOLA POSTS AND MORE.

**7**

Strengthen softer woods. TAP the 4x4 SUPPORT BRACKET into base of 4x4 post in a circular pattern.

**4x4 ONLY**

**8**

DRILL pilot holes with *masonry bit*.

**9**

INSERT 4 Set Screws and level the base with  $1/8"$  allen key.

**10**

3"  
 $1/4"$

SCREW Wedge Bolts® down.

**OPTIONAL**  
ADD some grease to the threads.

HAND TIGHTEN threaded stud until stud contacts substrate.

**11**

Use scrap material and  $3-1/2"$  screws to make *post wrench*.

**CHECK IT OUT!**

**BAD BOY POST WRENCH**  
Sold separately.

**12**

HAND TURN post on *threaded stud* to base. Once post contacts base, use *post wrench* to turn additional 180° maximum.

**FINISH**

APPLY wood filler and sand.

TITAN STRUCTURAL WOOD POST ANCHOR KIT / TSPA35 / TSPA55

PATENT NO

US 9,976,298

IN NO EVENT SHALL TITAN BUILDING PRODUCTS BE LIABLE FOR ANY LOSS OR DAMAGE, DIRECT OR OTHERWISE, WHICH RESULTS FROM THE IMPROPER INSTALLATION OR USE OF THIS PRODUCT. IF FOR ANY REASON TITAN BUILDING PRODUCTS BECOMES LIABLE FOR LOSS OR DAMAGE, DIRECT OR OTHERWISE, THE AGGREGATE LIABILITY OF TITAN BUILDING PRODUCTS SHALL BE LIMITED TO THE RETAIL PURCHASE PRICE OF THE PRODUCTS.

QUESTIONS? CONTACT US TOLL FREE

**1-866-577-8868**



titanbuildingproducts.com

